

2004 ELECTRICAL

Body Electrical Connectors & Harnesses - TSX

CONNECTORS AND HARNESSES

CONNECTOR INDEX

Identification numbers have been assigned to in-line connectors. The number is preceded by the letter "C" for connectors, "G" for ground terminals or "T" for non-ground terminals.

2004 Acura TSX

2004 ELECTRICAL Body Electrical Connectors & Harnesses - TSX

Harness	Location		
	Engine Compartment	Dashboard	Others (Floor, Door, Trunk, and Roof)
Battery ground cable	(-) G1		
Engine ground cable A	T1 G2		
Engine ground cable B	T2 G3		
Starter subharness	C101 and C151 T101 through T104 (+)		
Engine Wire harness	C101 and C102 C152 G101	C201 and C251	
Transmission range switch subharness	C152		
Front engine compartment wire harness (right branch)	G201		
Front engine compartment wire harness (left branch)	C301 G301		
Engine compartment wire harness (right branch)	G202 and G203		
Engine compartment wire harness (left branch)	C151 and C301 G302	C401 through C404	
Dashboard wire harness (left branch)		C401 through C407, C451, C501 and C502, C601, C851 G501 and G502, G504	
Dashboard wire harness (right branch)		C201, C551 through C556, C651, C731 and C732 G503, G505 and G506	
Floor wire harness (left side)		C501 and C502	C701, C751 and C901 G601 and G603
Floor wire harness (right side)		C551 and C552	C781 and C801 G602
Rear window defogger ground wire			G604
Rear wire harness			C702 and C703 G701
Roof wire harness		C601 and C651	
Cable reel subharness		C451	
Throttle actuator control module subharness		C251	
Driver's door wire harness			C631 and C632
Driver's door subharness			C631 and C632
Front passenger's door wire harness			C731 and C732
Left rear door wire harness			C751
Right rear door wire harness			C781
OPDS unit harness			
Side curtain airbag harness			
Driver's seat wire harness			C901
A/C wire harness		C851	

G01820782

Fig. 1: Connector Index

CONNECTOR TO HARNESS INDEX

Connector or Terminal	Ref	Cavities	Location	Connects to	Notes
G1	6		Left side of engine compartment	Body ground, via battery ground cable	
(-)	5		Battery	Battery negative terminal	

G01820783

Fig. 2: Battery Ground Cable

Connector or Terminal	Ref	Cavities	Location	Connects to	Notes
T1	2		Right side of engine compartment	Body ground, via battery ground cable	
G2	1		Right side of engine compartment	Body ground, via engine ground cable A	

G01820784

Fig. 3: Engine Ground Cable A

Connector or Terminal	Ref	Cavities	Location	Connects to	Notes
T2	3		Left side of engine compartment	Transmission housing	
G3	4		Left side of engine compartment	Body ground, via engine ground cable B	

G01820785

Fig. 4: Engine Ground Cable B

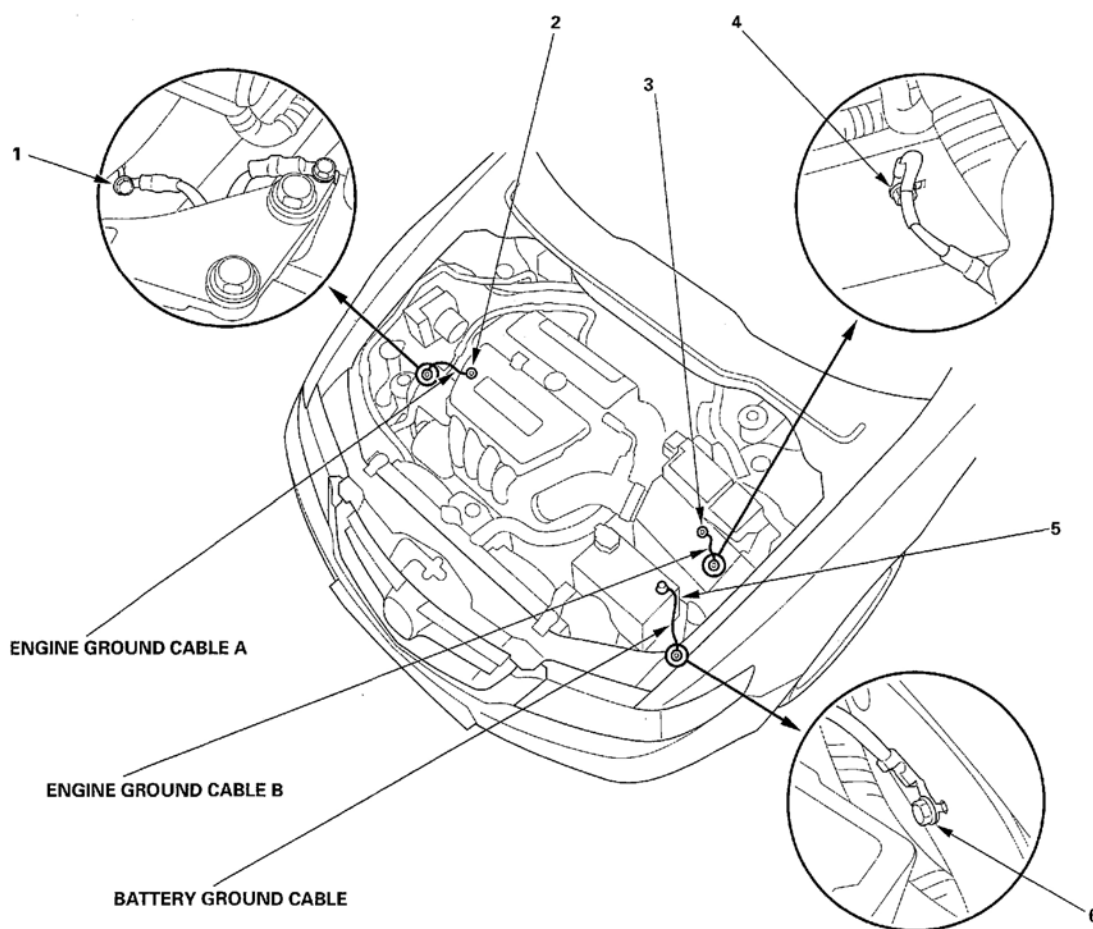

G01820786

Fig. 5: Locating Cables

2004 Acura TSX

2004 ELECTRICAL Body Electrical Connectors & Harnesses - TSX

Connector or Terminal	Ref	Cavities	Location	Connects to	Notes
Alternator	1	4	Middle of engine compartment	Engine wire harness	
Knock sensor	3	1	Middle of engine compartment		
Starter solenoid	5	1	Middle of engine compartment		
C101	10	6	Left side of engine compartment		
C151	8	1	Left side of engine compartment	Engine compartment wire harness	
T101	6		Left side of engine compartment	Under-hood fuse/relay box	
T102	7		Left side of engine compartment	Under-hood fuse/relay box	
T103	2		Alternator		
T104	4		Middle of engine compartment	Starter motor	
(+)	9		Battery	Battery positive terminal	

G01820787

Fig. 6: Starter Subharness

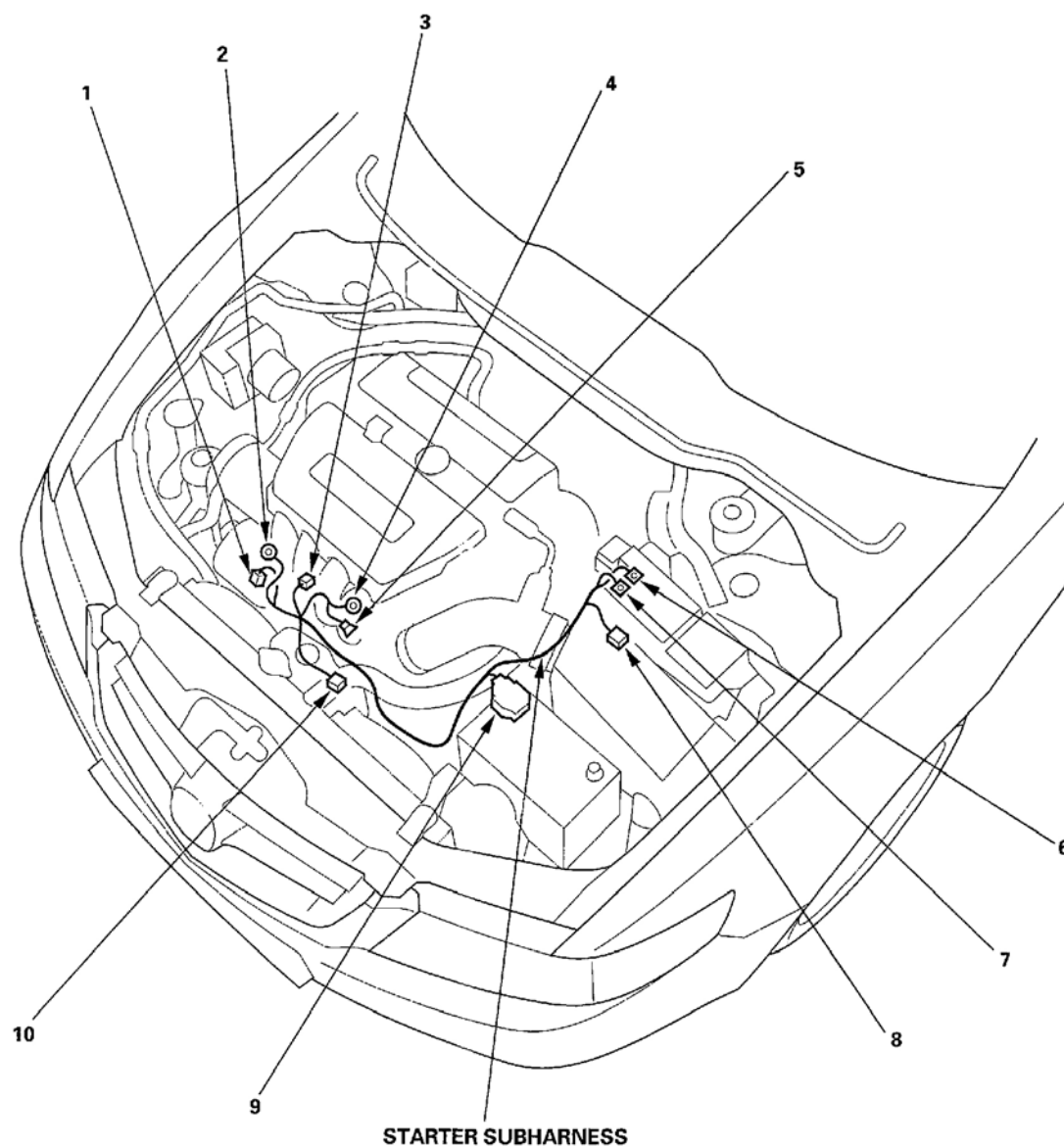

G01820788

2004 Acura TSX

2004 ELECTRICAL Body Electrical Connectors & Harnesses - TSX

Fig. 7: Locating Starter Subharness

Connector or Terminal	Ref	Cavities	Location	Connects to	Notes
A/F sensor 1	22	4	Left side of engine compartment		A/T
A/F sensor 1	20	4	Left side of engine compartment		M/T
A/T clutch pressure control solenoid valve connector A	24	2	Left side of engine compartment		
A/T clutch pressure control solenoid valve connector B	29	2	Left side of engine compartment		
A/T clutch pressure control solenoid valve connector C	27	2	Left side of engine compartment		
APP sensor	2	6	Right side of engine compartment		
Back-up light switch	26	2	Left side of engine compartment		M/T
CMP sensor A	13	3	Left side of engine compartment		
CMP sensor B	12	3	Left side of engine compartment		
CKP sensor	41	3	Right side of engine compartment		
Countershaft speed sensor	16	3	Left side of engine compartment		A/T
Countershaft speed sensor	21	3	Left side of engine compartment		M/T
EVAP canister purge valve	11	2	Left side of engine compartment		
Engine coolant temperature (ECT) sensor	14	2	Left side of engine compartment		
Engine mount control solenoid valve	40	2	Right side of engine compartment		
Engine oil pressure switch	43	1	Right side of engine compartment		
ECM/PCM connector A	6	31	Under middle of dash		
ECM/PCM connector B	7	24	Under middle of dash		
Ignition coil No. 1	1	3	Middle of engine compartment		
Ignition coil No. 2	4	3	Middle of engine compartment		
Ignition coil No. 3	9	3	Middle of engine compartment		
Ignition coil No. 4	10	3	Middle of engine compartment		
Injector No. 1	39	2	Middle of engine compartment		
Injector No. 2	38	2	Middle of engine compartment		
Injector No. 3	37	2	Middle of engine compartment		
Injector No. 4	35	2	Middle of engine compartment		
Intake air temperature (IAT) sensor	31	2	Left side of engine compartment		
MAP sensor	34	3	Left side of engine compartment		
Mainshaft speed sensor	15	3	Left side of engine compartment		A/T
PCM connector C	8	22	Under middle of dash		
Reverse lockout solenoid	17	2	Left side of engine compartment		M/T
Shift control solenoid valves/ATF temperature sensor	28	8	Left side of engine compartment		
Throttle body	32	6	Left side of engine compartment		
VTC oil control solenoid valve	42	2	Right side of engine compartment		
VTEC oil pressure switch	44	2	Right side of engine compartment		
VTEC solenoid valve	45	2	Right side of engine compartment		
2nd clutch pressure switch	30	1	Left side of engine compartment		A/T
3rd clutch pressure switch	23	1	Left side of engine compartment		A/T

G01820789

Fig. 8: Engine Wire Harness (1 Of 2)

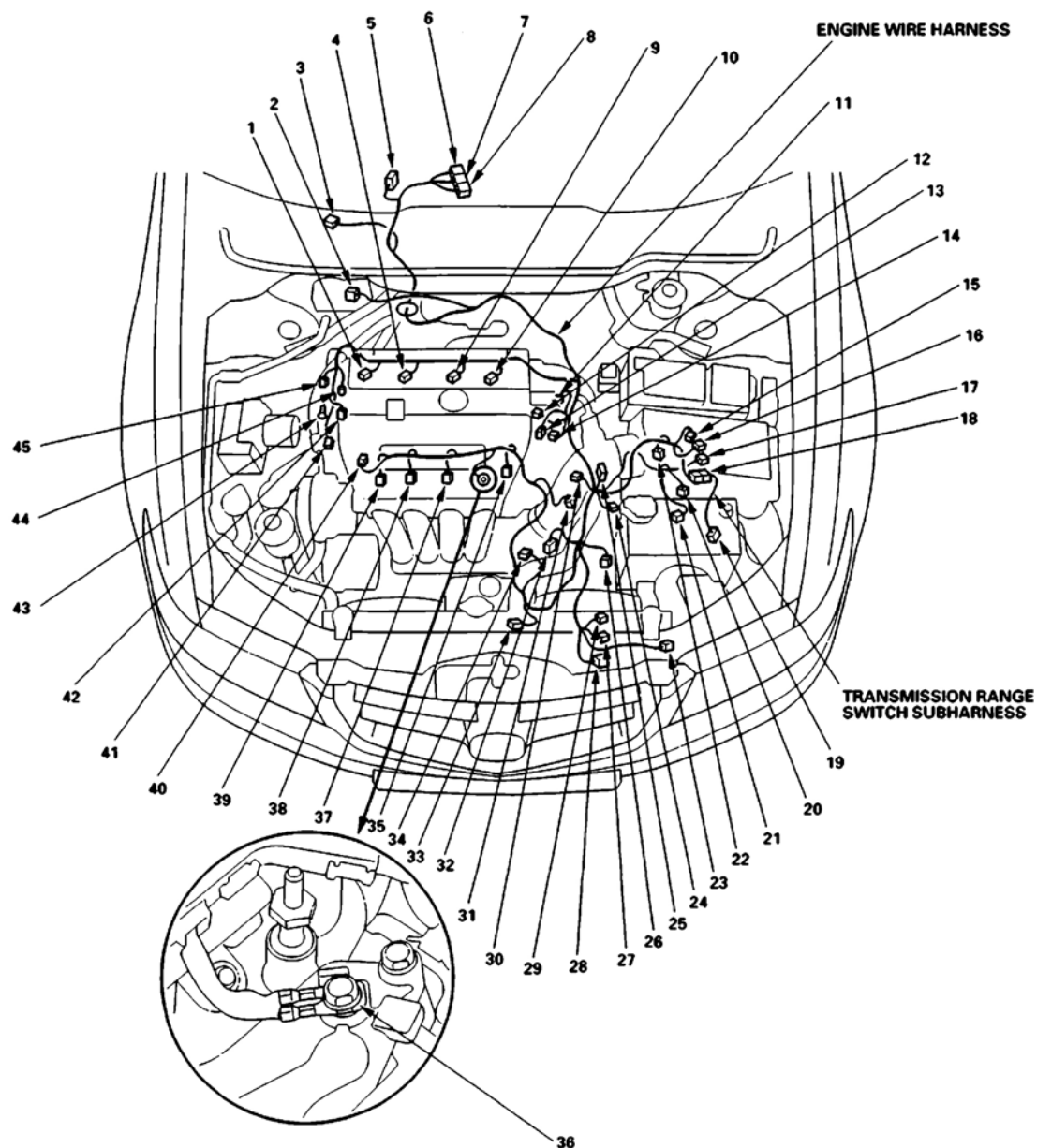

G01820790

Fig. 9: Locating Engine Wire Harness

2004 Acura TSX

2004 ELECTRICAL Body Electrical Connectors & Harnesses - TSX

Connector or Terminal	Ref	Cavities	Location	Connects to	Notes
C101	33	6	Left side of engine compartment	Starter subharness	
C102 (Junction connector)	25	24	Left side of engine compartment		
C152	18	10	Transmission housing	Transmission range switch subharness	
C201	5	13	Under middle of dash	Dashboard wire harness	
C251	3	13	Under right side of dash	Throttle actuator control module subharness	
G101	36		Middle of engine compartment	Engine ground via engine wire harness	

G01820791

Fig. 10: Engine Wire Harness (2 Of 2)

Connector or Terminal	Ref	Cavities	Location	Connects to	Notes
Transmission range switch	19	10	Transmission housing		
C152	18	10	Transmission housing	Engine wire harness	

G01820792

Fig. 11: Transmission Range Switch Subharness

2004 Acura TSX

2004 ELECTRICAL Body Electrical Connectors & Harnesses - TSX

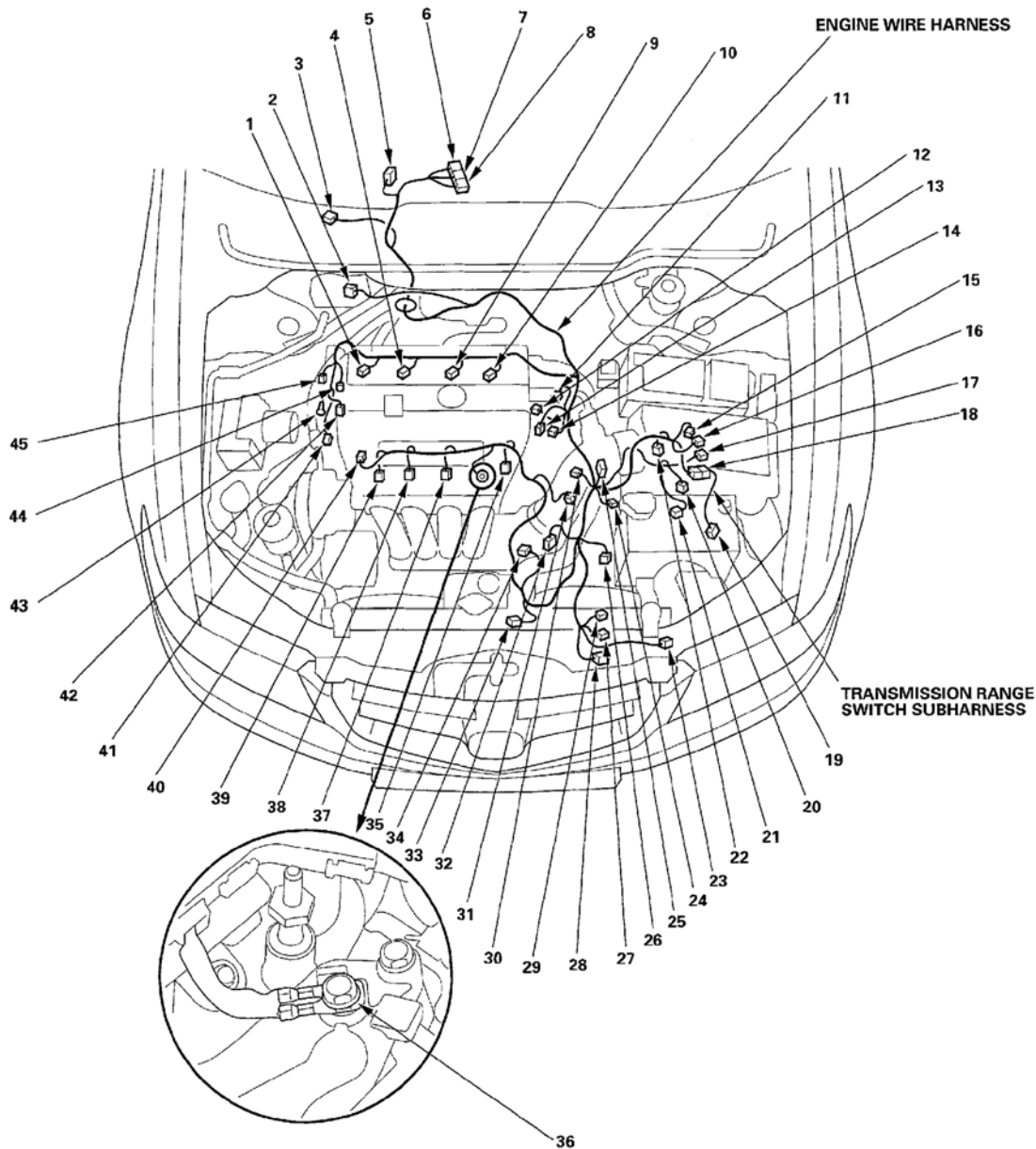

G01820793

Fig. 12: Locating Transmission Range Switch Subharness

Connector or Terminal	Ref	Cavities	Location	Connects to	Notes
A/C compressor clutch	7	3	Right side of engine compartment		
A/C pressure switch	4	2	Right side of engine compartment		
Condenser fan motor	8	2	Right side of engine compartment		
Horn (high)	9	1	Behind middle of front bumper		
Right front parking light	1	2	Behind right headlight		
Right front turn signal light	5	2	Behind right headlight		
Right headlight (high)	6	3	Behind right headlight		
Right headlight (low)	2	2	Behind right headlight		
G201	3		Right side of engine compartment	Body ground, via front engine compartment wire harness	

G01820794

Fig. 13: Front Engine Compartment Wire Harness (Right Branch)

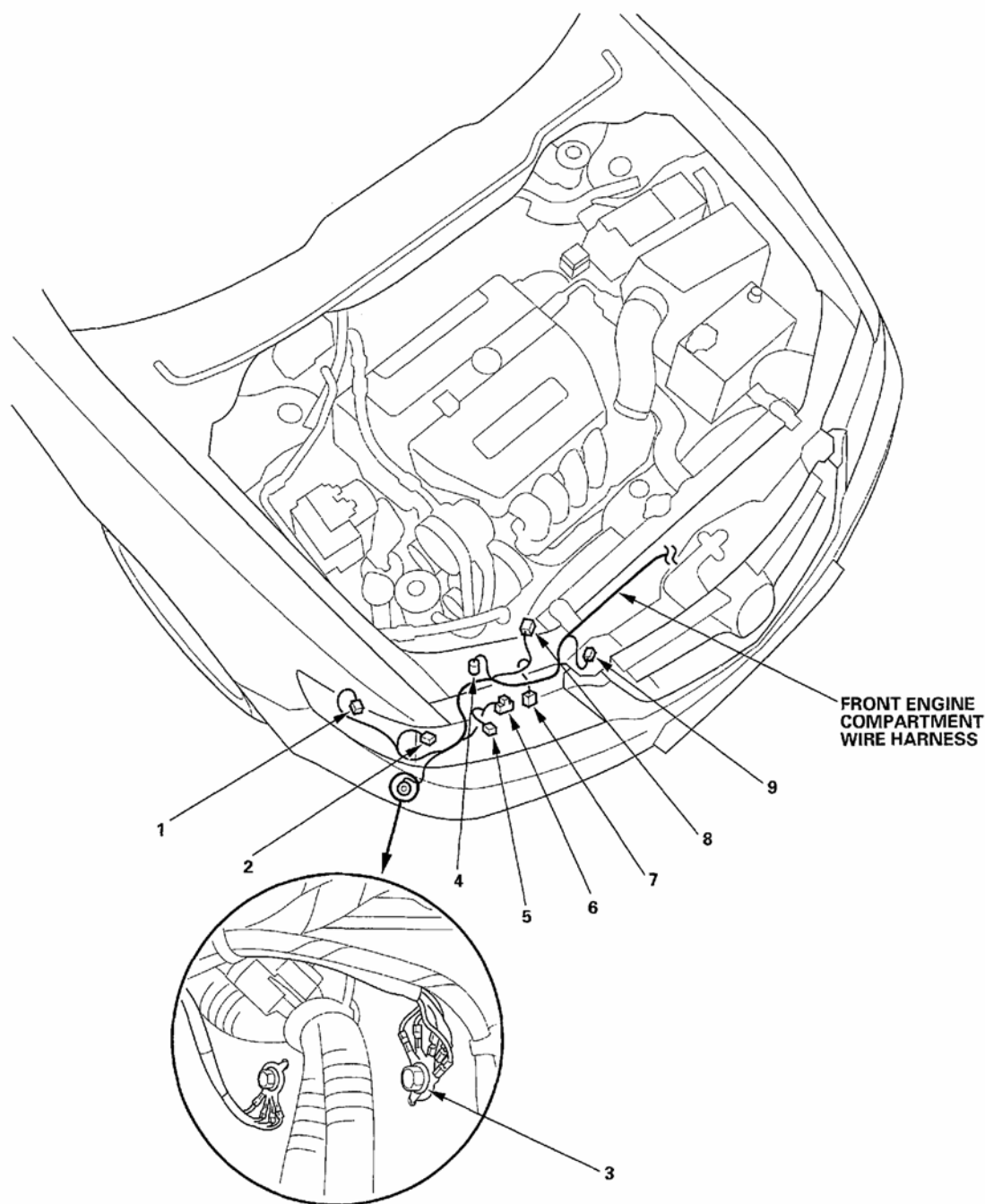

G01820795

Fig. 14: Locating Front Engine Compartment Wire Harness (Right Branch)

2004 Acura TSX

2004 ELECTRICAL Body Electrical Connectors & Harnesses - TSX

Connector or Terminal	Ref	Cavities	Location	Connects to	Notes
Hood switch	14	2	Behind middle of front bumper		
Horn (low)	11	1	Behind middle of front bumper		
Left front parking light	5	2	Behind left headlight		
Left front turn signal light	8	2	Behind left headlight		
Left headlight (high)	9	3	Behind left headlight		
Left headlight (low)	6	2	Behind left headlight		
Outside air temperature sensor	13	2	Middle of engine compartment		
Radiator fan motor	12	2	Left side of engine compartment		
Radiator fan switch	10	2	Left side of engine compartment		
Under-hood fuse/relay box connector F	2	20	Behind under-hood fuse/relay box		
Under-hood fuse/relay box connector H	3	14	Behind under-hood fuse/relay box		
Under-hood multi-relay box	1	5	In multi-relay box		Canada
C301	4	6	Left side of engine compartment	Engine compartment wire harness	Canada
G301	7		Left side of engine compartment	Body ground, via front engine compartment wire harness	

G01820796

Fig. 15: Front Engine Compartment Wire Harness (Left Branch)

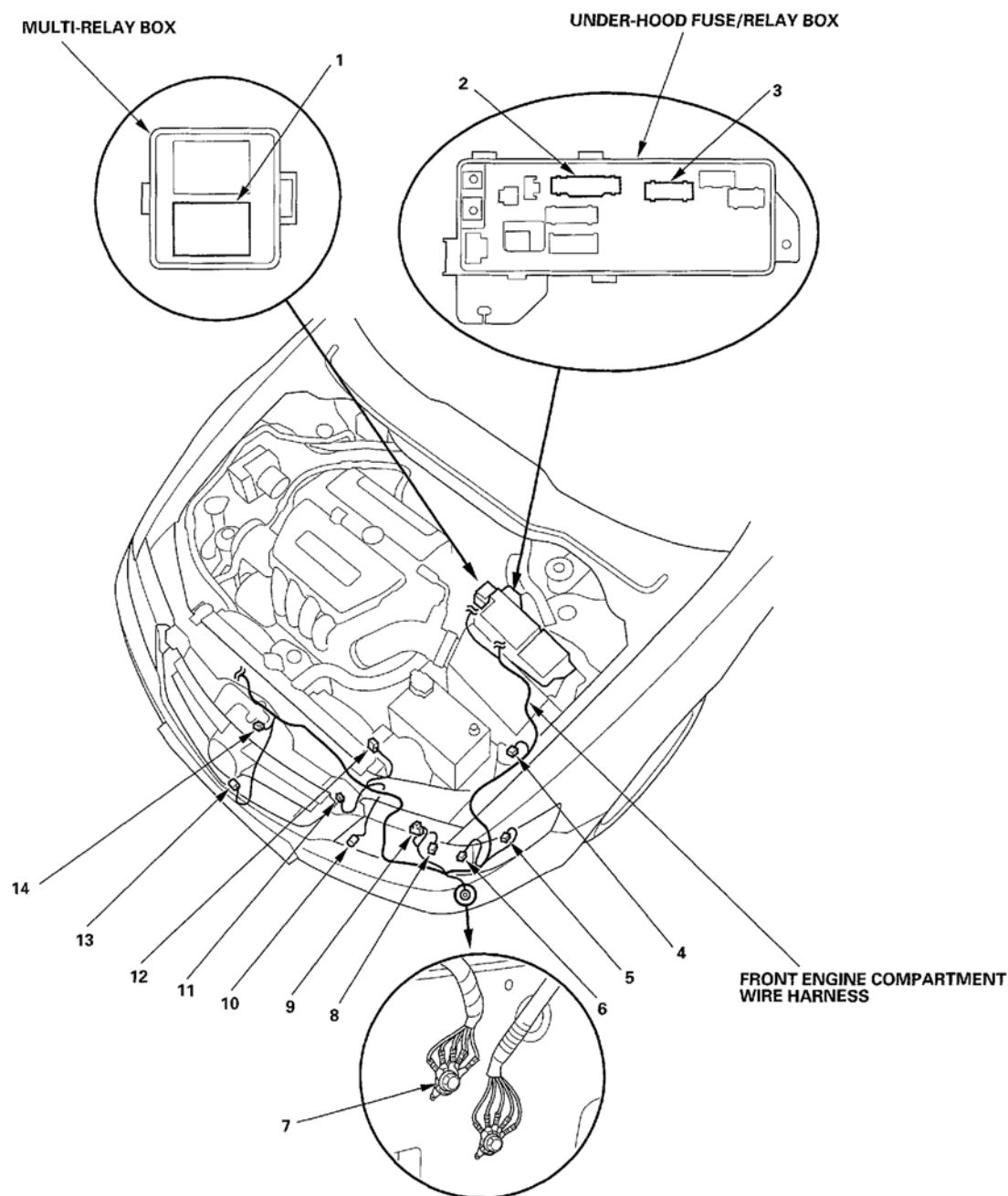

G01820797

Fig. 16: Locating Front Engine Compartment Wire Harness (Left Branch)

2004 Acura TSX

2004 ELECTRICAL Body Electrical Connectors & Harnesses - TSX

Connector or Terminal	Ref	Cavities	Location	Connects to	Notes
ABS right front wheel sensor	1	2	Right side of engine compartment		
Power steering pressure (PSP) switch	2	2	Right side of engine compartment		
Right front airbag sensor	7	2	Right side of engine compartment		
VSA modulator-control unit	8	47	Right side of engine compartment		
Washer fluid level switch	5	2	Behind right of front bumper		Canada
Windshield washer motor	4	2	Behind right of front bumper		
G202	6		Right side of engine compartment	Body ground, via engine compartment wire harness	
G203	3		Right side of engine compartment	Body ground, via engine compartment wire harness	

G01820798

Fig. 17: Engine Compartment Wire Harness (Right Branch)

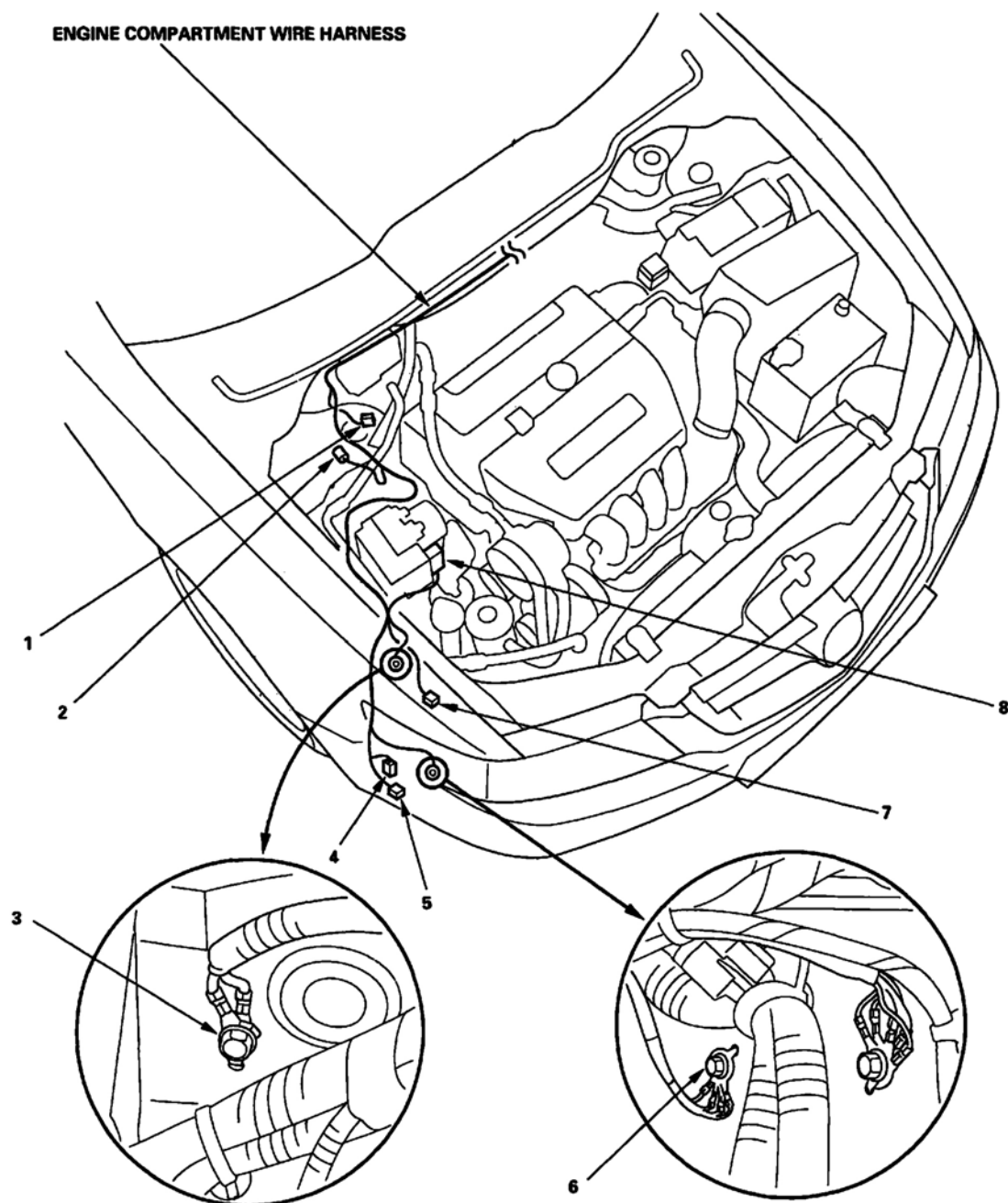

G01820799

Fig. 18: Locating Engine Compartment Wire Harness (Right Branch)

2004 Acura TSX

2004 ELECTRICAL Body Electrical Connectors & Harnesses - TSX

Connector or Terminal	Ref	Cavities	Location	Connects to	Notes
ABS left front wheel sensor	19	2	Left side of engine compartment		
Brake fluid level switch	8	2	Left side of engine compartment		
Left front airbag sensor	23	2	Left side of engine compartment		
Optional connector A	12	2	Left side of dash		
Optional connector B	18	2	Left side of engine compartment		
Under-dash fuse/relay box connector B	14	6	Under left side of dash		
Under-dash fuse/relay box connector C	15	12	Under left side of dash		
Under-dash fuse/relay box connector D	13	17	Under left side of dash		
Under-hood fuse/relay box connector A (ELD unit)	6	3	In under-hood fuse/relay box		
Under-hood fuse/relay box connector C	1	2	Behind under-hood fuse/relay box		
Under-hood fuse/relay box connector D	7	9	Behind under-hood fuse/relay box		
Under-hood fuse/relay box connector E	2	16	Behind under-hood fuse/relay box		
Under-hood fuse/relay box connector G	5	2	Behind under-hood fuse/relay box		
Under-hood fuse/relay box connector J	4	10	Behind under-hood fuse/relay box		
Under-hood fuse/relay box connector J	3	5	Behind under-hood fuse/relay box		
Windshield wiper motor	9	5	Left side of engine compartment		
C151	20	1	Left side of engine compartment	Starter subharness	
C301	22	6	Left side of engine compartment	Front engine compartment wire harness	Canada
C401	16	20	Under left side of dash	Dashboard wire harness	
C402	10	1	Under left side of dash	Dashboard wire harness	
C403	17	4	Under left side of dash	Dashboard wire harness	
C404	11	13	Under left side of dash	Dashboard wire harness	
G302	21		Left side of engine compartment	Body ground, via engine compartment wire harness	

G01820800

Fig. 19: Engine Compartment Wire Harness (Left Branch)

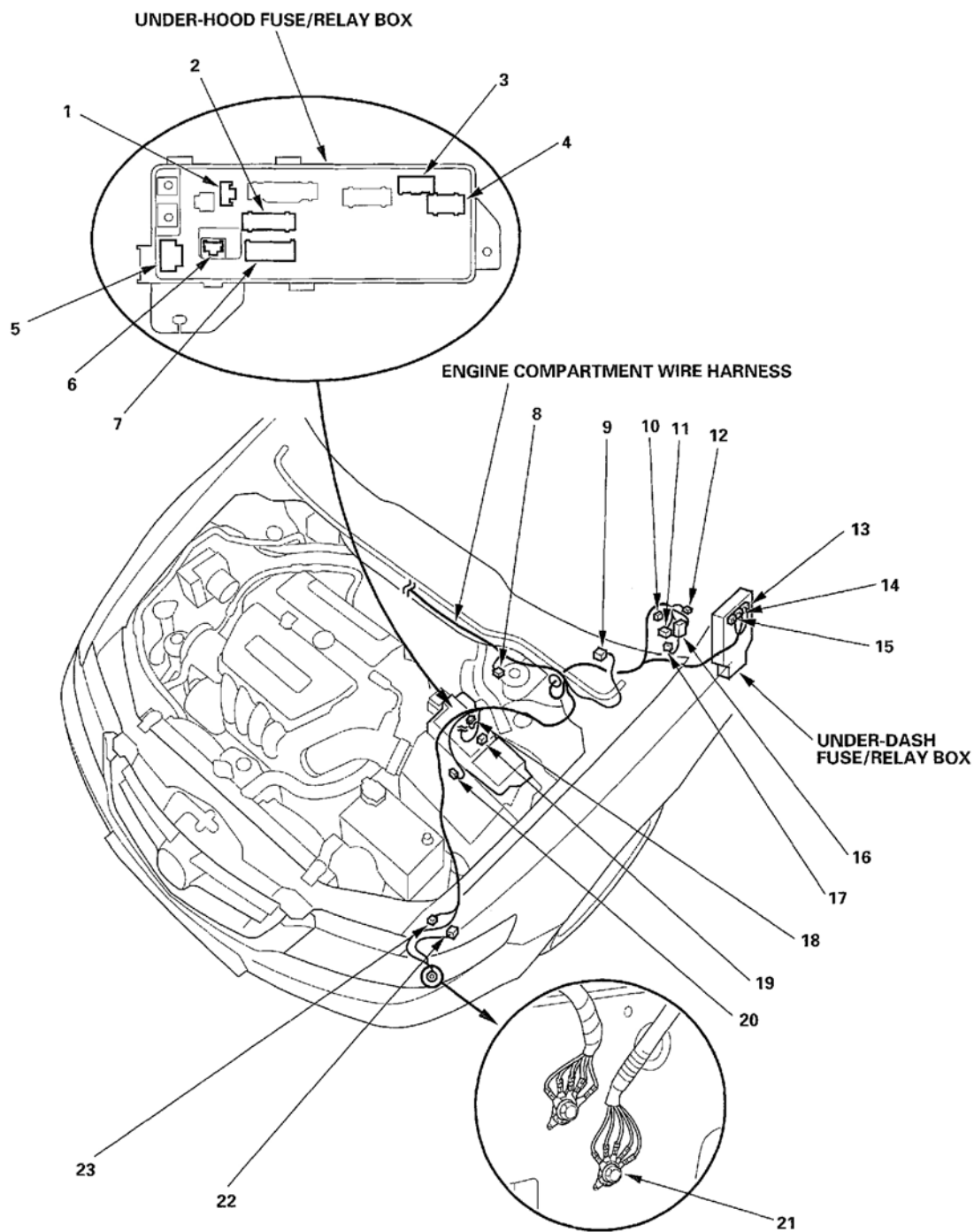

G01820801

Fig. 20: Locating Engine Compartment Wire Harness (Left Branch)

2004 Acura TSX

2004 ELECTRICAL Body Electrical Connectors & Harnesses - TSX

Connector or Terminal	Ref	Cavities	Location	Connects to	Notes
Antenna lead	19	1	Under middle of dash		
Audio-HVAC display panel unit connector A	15	22	Under middle of dash		
Audio-HVAC display panel unit connector B	16	16	Under middle of dash		
Audio-HVAC display panel unit connector C	14	10	Under middle of dash		
Audio unit connector A	20	20	Under middle of dash		
Audio unit connector B	22	14	Under middle of dash		
Brake pedal position switch	33	4	Under left side of dash		
Clutch interlock switch	36	2	Under left side of dash		M/T
Clutch pedal position switch	37	3	Under left side of dash		M/T
Combination switch control unit	21	8	In steering column cover		
Data link connector (DLC)	39	16	Under left side of dash		
Driver's airbag inflator	31	4	In steering column cover		
Gauge control module connector A	12	22	Behind gauges assembly		
Gauge control module connector B	9	18	Behind gauges assembly		
Hazard warning switch	13	5	Middle of dash		
Ignition switch	26	7	In steering column cover		
Immobilizer control unit-receiver	30	7	In steering column cover		
Ignition key switch	27	6	In steering column cover		
In-car temperature sensor	23	2	Under left side of dash		
Moonroof switch	38	6	Under left side of dash		
Navigation display unit	17	20	Under middle of dash		
Sunlight sensor	11	2	Middle of dash		
Stereo amplifier connector A	24	14	Under middle of dash		
Stereo amplifier connector B	25	20	Under middle of dash		
Steering angle sensor	32	5	Under middle of dash		
Tweeter (left side)	5	2	In steering column cover		
Under-dash fuse/relay box connector A	45	6	Left kick panel		
Under-dash fuse/relay box connector N	46	45	Left kick panel		
Under-dash fuse/relay box connector P [Multiplex integrated control unit (MICU)]	43	30	Left kick panel		
Under-dash fuse/relay box connector Q [Multiplex integrated control unit (MICU)]	44	14	Left kick panel		
Under-dash fuse/relay box connector R	47	2	Left kick panel		
Under-dash fuse/relay box connector S	48	2	Left kick panel		
Under-dash fuse/relay box connector X	42	39	Left kick panel		
VSA off switch	35	5	Under left side of dash		

G01820802

Fig. 21: Dashboard Wire Harness (Left Branch - 1 Of 2)

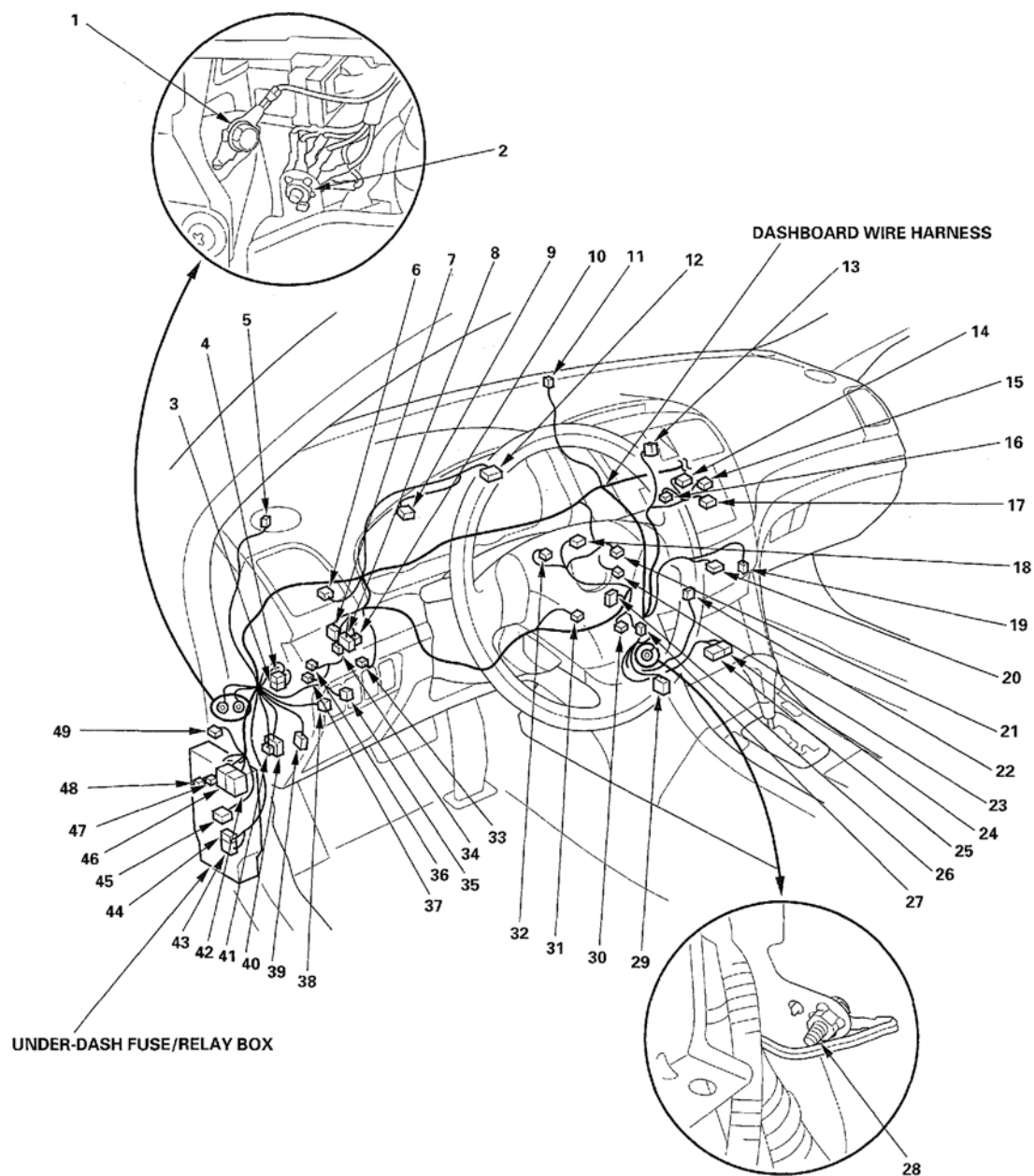

G01820803

Fig. 22: Locating Dashboard Wire Harness (Left Branch)

2004 Acura TSX

2004 ELECTRICAL Body Electrical Connectors & Harnesses - TSX

Connector or Terminal	Ref	Cavities	Location	Connects to	Notes
C401	8	20	Under left side of dash	Engine compartment wire harness	
C402	34	1	Under left side of dash	Engine compartment wire harness	
C403	10	4	Under left side of dash	Engine compartment wire harness	
C404	7	13	Under left side of dash	Engine compartment wire harness	
C405 (Junction connector A)	6	28	Under left side of dash		
C406 (Junction connector B)	4	28	Under left side of dash		
C407 (Junction connector C)	3	28	Under left side of dash		
C451	18	13	In steering column cover	Cable reel subharness	
C501	40	24	Under left side of dash	Floor wire harness	
C502	41	4	Under left side of dash	Floor wire harness	
C601	49	10	Under left side of dash	Roof wire harness	
C851	29	21	Under middle of dash	A/C wire harness	
G501	2		Behind left side of dash	Body ground, via dashboard wire harness	
G502	1		Behind left side of dash	Body ground, via dashboard wire harness	
G504	28		Under middle of dash	Body ground, via dashboard wire harness	

G01820804

Fig. 23: Dashboard Wire Harness (Left Branch - 2 Of 2)

Connector or Terminal	Ref	Cavities	Location	Connects to	Notes
Audio-HVAC sub display unit	5	10	Middle of dash		with navigation
Blower motor	20	2	Under right side of dash		
Center pocket light	4	2	Behind center console		
Clock	5	10	Middle of dash		without navigation
Driver's seat heater switch	31	6	Under console panel		
ECM/PCM connector D	26	31	Under middle of dash		
ECM/PCM connector E	25	17	Under middle of dash		
Front accessory power socket	2	2	Under console panel		
Front passenger's airbag inflator	6	4	Under right side of dash		
Front passenger's seat heater switch	29	6	Under console panel		
Glove box light	22	2	Under right side of dash		
Park pin switch/transmission gear selection switch/A/T gear position console light	30	8	Under console panel		A/T
Parking brake switch	32	1	Behind rear console		
Power transistor	21	4	Under right side of dash		
Rear accessory power socket	33	2	Behind rear console		
SRS unit connector A	3	28	Under console panel		
Seat heater relay	12	4	Under right side of dash		
Shift lock solenoid	28	2	Under console panel		A/T
Trunk Lid opener main switch	23	2	Under right side of dash		
Tweeter (right)	13	2	Right side of dash		
Throttle actuator control relay	11	4	Under right side of dash		

G01820806

Fig. 24: Dashboard Wire Harness (Right Branch - 1 Of 2)

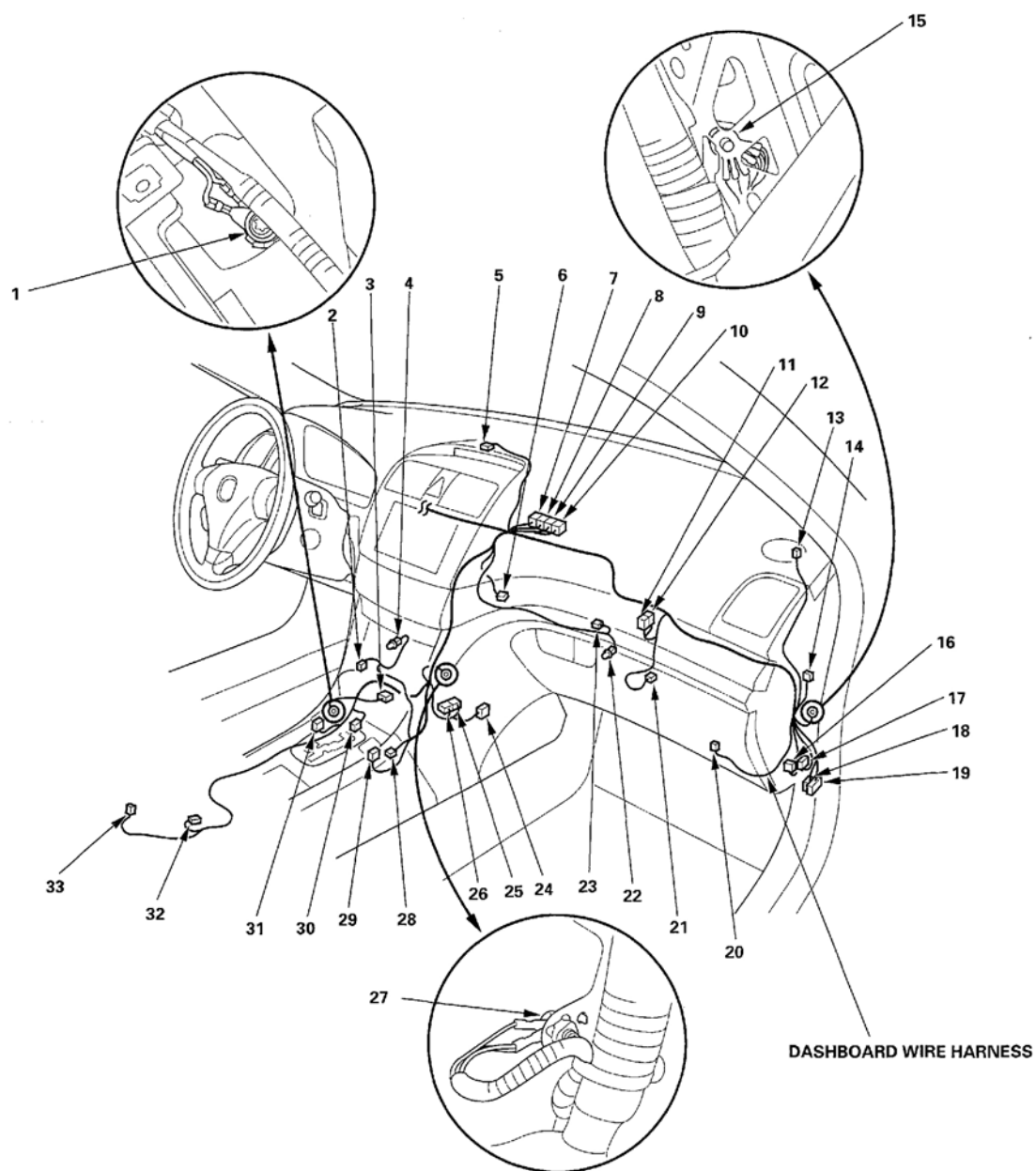

G01820807

Fig. 25: Locating Dashboard Wire Harness (Right Branch)

2004 Acura TSX

2004 ELECTRICAL Body Electrical Connectors & Harnesses - TSX

Connector or Terminal	Ref	Cavities	Location	Connects to	Notes
C201	24	13	Under middle of dash	Engine wire harness	
C551	18	14	Under right side of dash	Floor wire harness	
C552	19	21	Under right side of dash	Floor wire harness	Navigation
C553 (Junction connector A)	7	28	Under right side of dash		
C554 (Junction connector B)	8	28	Under right side of dash		
C555 (Junction connector C)	9	28	Under right side of dash		
C556 (Junction connector D)	10	28	Under right side of dash		
C651	14	6	Under right side of dash	Roof wire harness	Navigation
C731	16	13	Under right side of dash	Front passenger's door wire harness	
C732	17	12	Under right side of dash	Front passenger's door wire harness	
G503	15		Behind right side of dash	Body ground, via dashboard wire harness	
G505	1		Under middle of dash	Body ground, via dashboard wire harness	
G506	27		Under middle of dash	Body ground, via dashboard wire harness	

G01820808

Fig. 26: Dashboard Wire Harness (Right Branch - 2 Of 2)

Connector or Terminal	Ref	Cavities	Location	Connects to	Notes
ABS left rear wheel sensor	11	2	Under left side of vehicle		
Driver's door switch	19	1	Left B-pillar		
Driver's seat belt tensioner	18	4	Left B-pillar		
Driver's side airbag inflator	17	2	Under driver's seat		
Driver's side impact sensor	20	2	Under driver's seat		
EVAP canister vent shut valve	12	2	Under left side of vehicle		
Fuel pump/fuel gauge sending unit	6	5	Fuel tank		
Fuel tank pressure (FTP) sensor	13	3	Under left side of vehicle		
Left rear door switch	10	1	Left C-pillar		
Noise condenser	8	2	Under left side seatback		
Under-dash fuse/relay box connector E	2	16	Under left side of dash		
Under-dash fuse/relay box connector F	1	14	Under left side of dash		
Under-dash fuse/relay box connector H	3	14	Under left side of dash		
Window antenna coil	7	1	Left C-pillar		
Yaw rate-lateral acceleration sensor	15	5	Under driver's seat		
C501	21	24	Under left side of dash	Dashboard wire harness	
C502	22	4	Under left side of dash	Dashboard wire harness	
C701	9	18	Left side of trunk	Rear wire harness connectors C702 and C703 via junction connector	
C751	16	17	Left B-pillar	Left rear door wire harness	
C901	14	10	Under driver's seat	Driver's seat wire harness	
G601	4		Left side of floor	Body ground, via floor wire harness	
G603	5		Left front of trunk	Body ground, via floor wire harness	

G01820810

Fig. 27: Floor Wire Harness (Left Side)

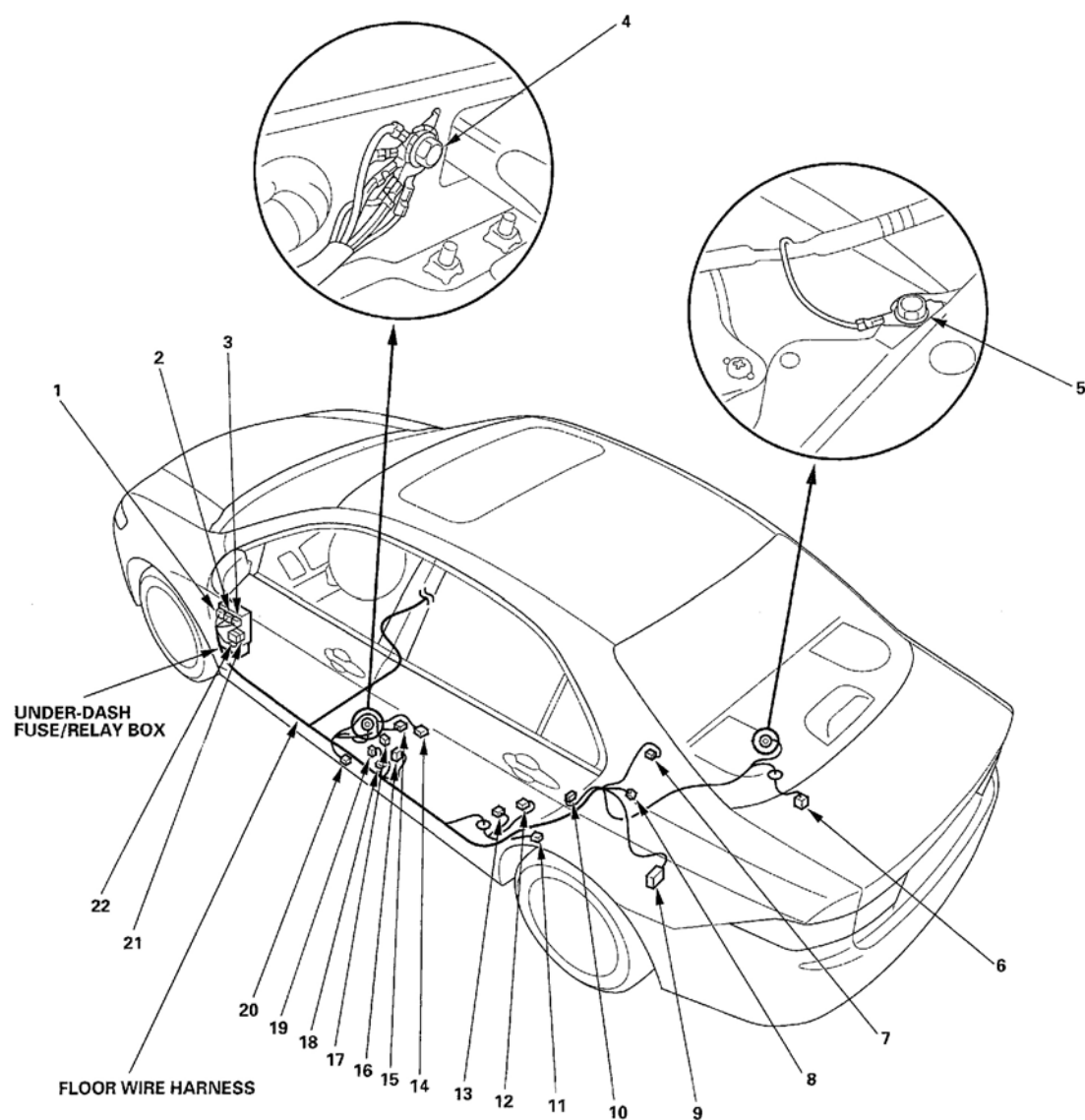

G01820811

Fig. 28: Locating Floor Wire Harness (Left Side)

2004 Acura TSX

2004 ELECTRICAL Body Electrical Connectors & Harnesses - TSX

Connector or Terminal	Ref	Cavities	Location	Connects to	Notes
ABS right rear wheel sensor	14	2	Under right side of vehicle		
Front passenger's door switch	10	1	Right B-pillar		
Front passenger's seat belt switch	7	3	Under front passenger's seat		
Front passenger's seat belt tensioner	11	4	Right B-pillar		
Front passenger's seat heater	6	4	Under front passenger's seat		
Front passenger's side airbag inflator	2	2	Under front passenger's seat		
Front passenger's side impact sensor	8	2	Under front passenger's seat		
High mount brake light	22	2	Middle of rear shelf		
Left rear speaker	17	2	Left side of rear shelf		
Navigation inspection connector	24	2	Right side of rear shelf		
Navigation unit connector A	19	20	Middle of rear shelf		
Navigation unit connector B	20	14	Middle of rear shelf		
Navigation unit connector C	18	8	Middle of rear shelf		
Right rear door switch	15	1	Right C-pillar		
Right rear speaker	23	2	Right side of rear shelf		
Secondary heated oxygen sensor	9	4	Under front passenger's seat		
SRS unit connector B	1	28	Under middle of dash		
Trunk light	21	2	Under middle of rear shelf		
C551	4	14	Under right side of dash	Dashboard wire harness	
C552	5	21	Under right side dash	Dashboard wire harness	Navigation
C781	12	17	Right B-pillar	Right rear door wire harness	
C801	3	4	Under front passenger's seat	OPDS unit harness	
G602	13		Right side of floor	Body ground, via floor wire harness	

G01820812

Fig. 29: Floor Wire Harness (Right Side)

Connector or Terminal	Ref	Cavities	Location	Connects to	Notes
Rear window defogger connector B	16	1	Right C-pillar		
G604	25		Right C-pillar	Body ground, via rear window defogger ground wire	

G01820813

Fig. 30: Rear Window Defogger Ground Wire

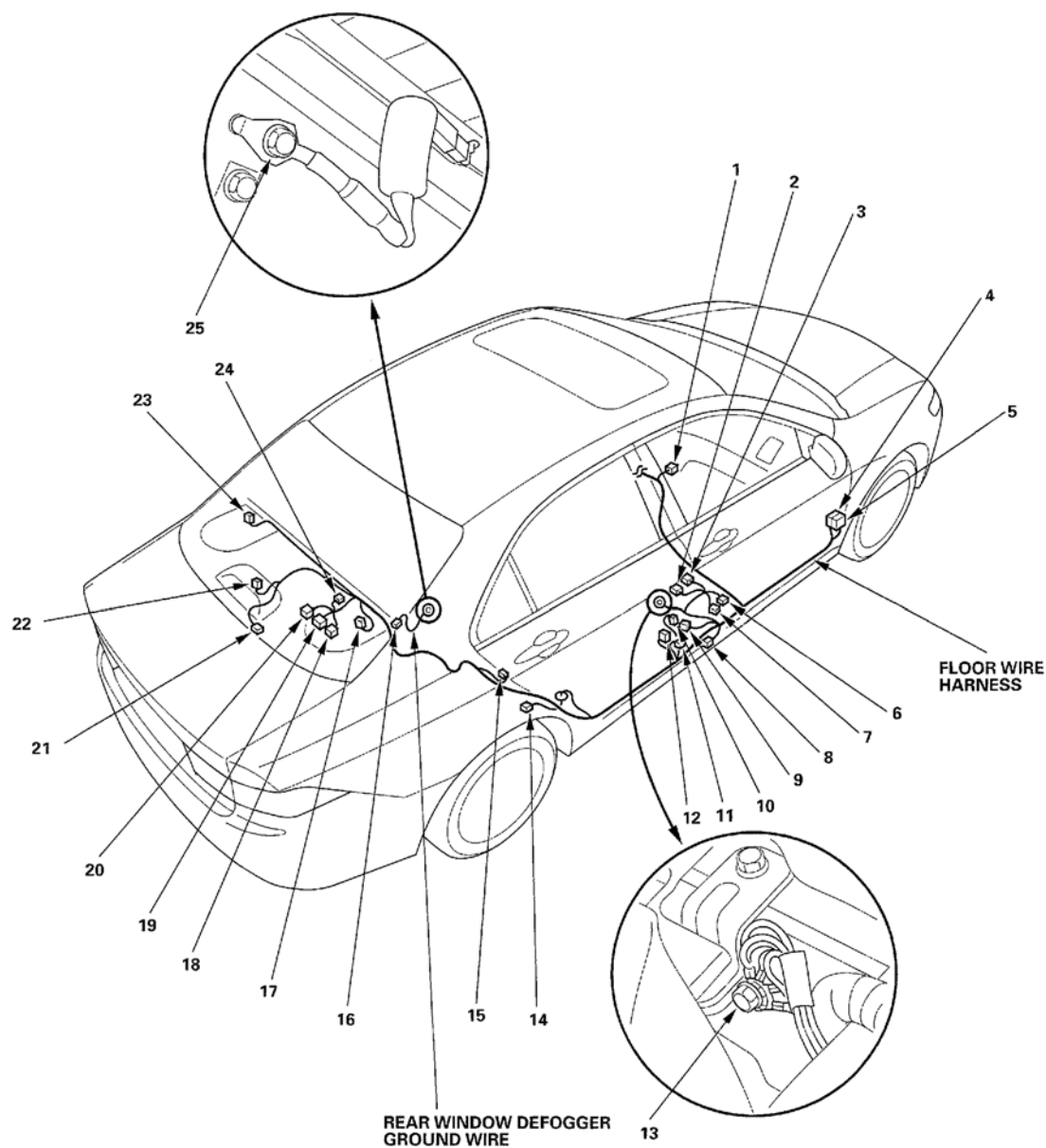

G01820814

Fig. 31: Locating Floor Wire Harness (Right Side) & Rear Window Defogger Ground Wire

2004 Acura TSX

2004 ELECTRICAL Body Electrical Connectors & Harnesses - TSX

Connector or Terminal	Ref	Cavities	Location	Connects to	Notes
Left back-up light	11	3	Left side of trunk lid		
Left inner taillight	12	2	Left side of trunk lid		
Left rear turn signal light	15	3	Left side of trunk		
Left rear side marker light	14	2	Left side of trunk		
Left taillight	13	4	Left side of trunk		
License plate light connector A	9	2	Behind middle of trunk lid		
License plate light connector B	6	2	Behind middle of trunk lid		
Right back-up light	5	3	Right side of trunk lid		
Right inner taillight	4	2	Right side of trunk lid		
Right rear turn signal light	1	3	Right side of trunk		
Right rear side marker light	2	2	Right side of trunk		
Right taillight	3	4	Right side of trunk		
Trailer lighting connector	16	2	Left side of trunk		
Trunk latch switch/trunk lid opener solenoid	7	3	Behind middle of trunk lid		
Trunk lid opener switch C702	8	2	Behind middle of trunk lid		
	17	14	Left side of trunk	Floor wire harness connector C701 via junction connector	
C703	18	10	Left side of trunk	Floor wire harness connector C701 via junction connector	
G701	10		Left side of trunk	Body ground, via rear wire harness	

G01820815

Fig. 32: Rear Wire Harness

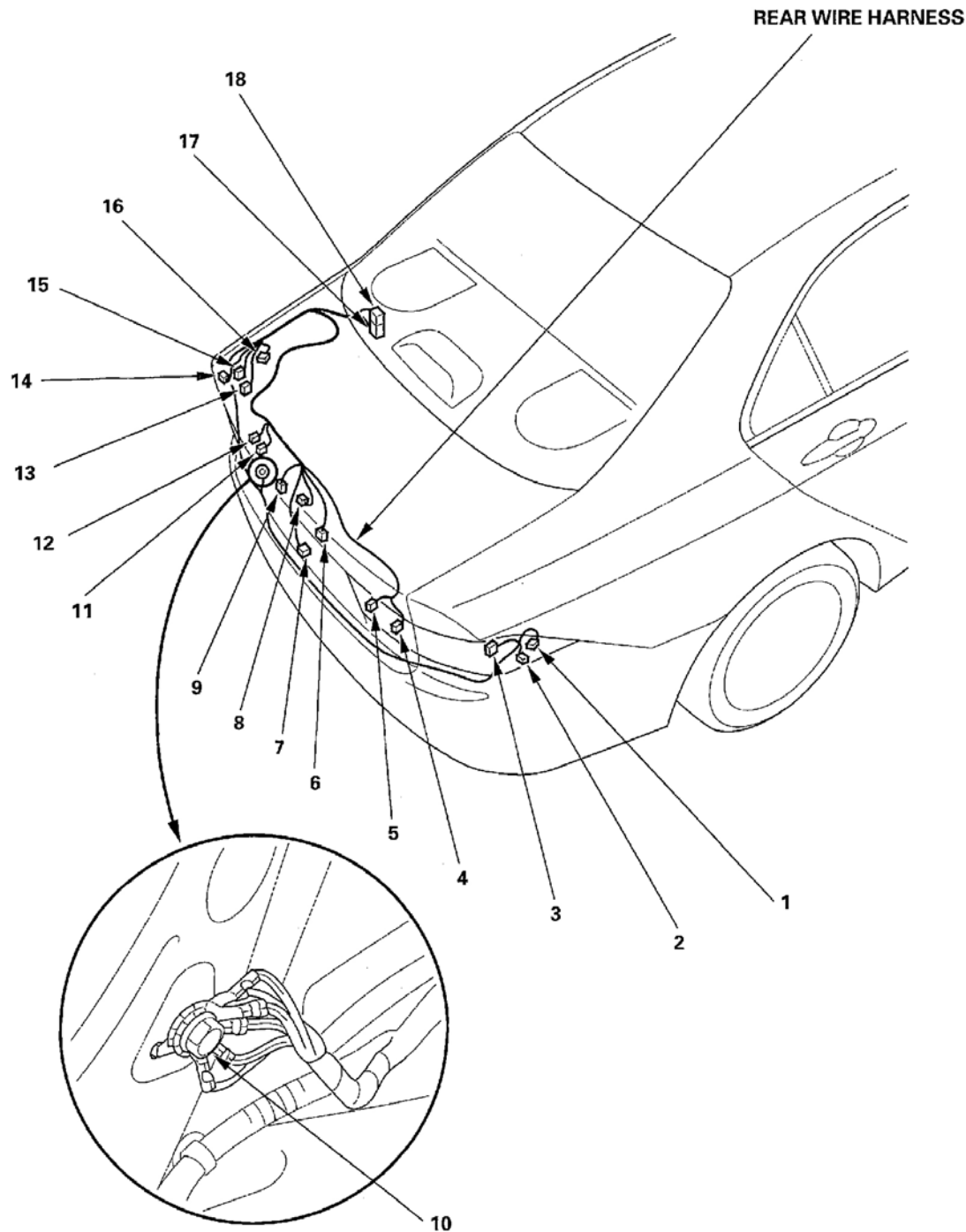

G01820816

Fig. 33: Locating Rear Wire Harness

2004 Acura TSX

2004 ELECTRICAL Body Electrical Connectors & Harnesses - TSX

Connector or Terminal	Ref	Cavities	Location	Connects to	Notes
Front ceiling light/Homelink	5	10	Roof		
Automatic inside dimming mirror	4	7	Behind rearview mirror		
Ceiling light	11	3	Roof		
Driver's vanity mirror light	6	2	Roof		
Front passenger's vanity mirror light	2	2	Roof		
Individual map light	3	3	Roof		
Moonroof close relay	9	5	Roof		
Moonroof motor	7	2	Right side of trunk		
Moonroof open relay	8	5	Roof		
Moonroof Limit Switch	10	4	Roof		
Under-dash fuse/relay box connector I	12	5	Under left side of dash		
C601	13	10	Under left side of dash	Dashboard wire harness	
C651	1	6	Under right side of dash	Dashboard wire harness	Navigation

G01820817

Fig. 34: Roof Wire Harness

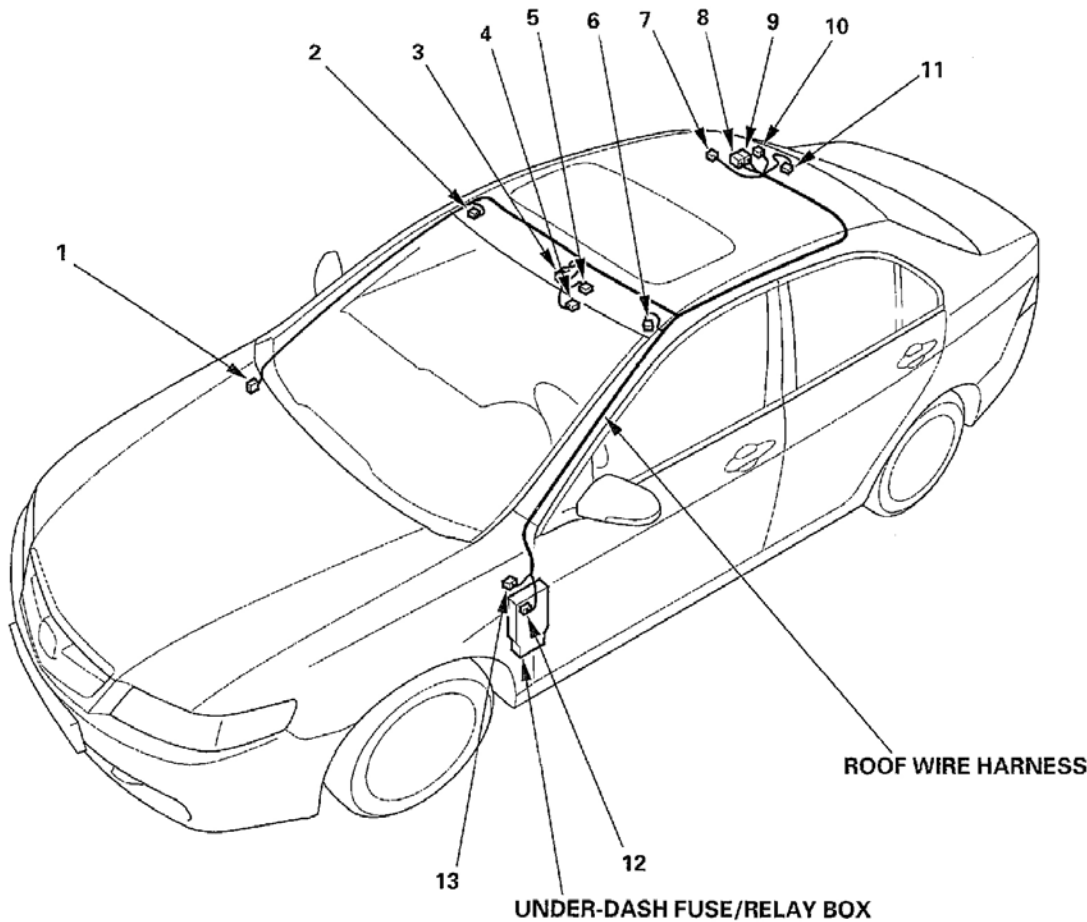

G01820818

Fig. 35: Locating Roof Wire Harness

2004 Acura TSX

2004 ELECTRICAL Body Electrical Connectors & Harnesses - TSX

Connector or Terminal	Ref	Cavities	Location	Connects to	Notes
Cruise Set/Resume/Cancel switch	5	5	In steering column cover	Dashboard wire harness	
Horn switch	4	1	In steering column cover		
Voice control switch	2	4	In steering column cover		
Radio remote switch	1	4	In steering column cover		
C451	3	13	In steering column cover		

G01820819

Fig. 36: Cable Reel Subharness

Connector or Terminal	Ref	Cavities	Location	Connects to	Notes
Throttle actuator control module	7	16	Under right side of dash	Engine wire harness	
C251	6	13	Under right side of dash		

G01820820

Fig. 37: Throttle Actuator Control Module Subharness

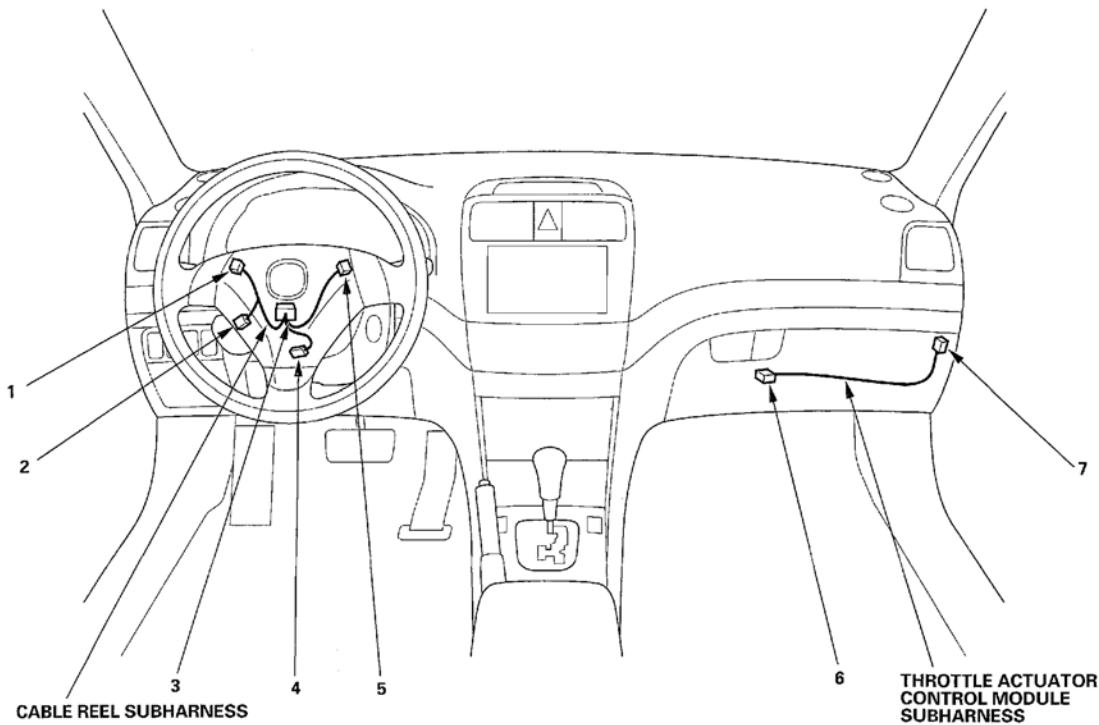

G01820821

Fig. 38: Locating Cable Reel Subharness & Throttle Actuator Control Module Subharness

2004 Acura TSX

2004 ELECTRICAL Body Electrical Connectors & Harnesses - TSX

Connector or Terminal	Ref	Cavities	Location	Connects to	Notes
Door multiplex control unit	2	23	Driver's door		
Driver's door courtesy light	11	2	Driver's door		
Driver's door key cylinder switch	1	3	Driver's door		
Driver's door lock actuator	12	2	Driver's door		
Driver's door lock knob switch	13	3	Driver's door		
Driver's door speaker	9	2	Driver's door		
Driver's power window motor	10	6	Driver's door		
Left power mirror/left side turn signal light	4	13	Driver's door		
Power mirror switch	3	13	Driver's door		
C631	5	20	Driver's door	Driver's door subharness	
C632	8	17	Driver's door	Driver's door subharness	

G01820822

Fig. 39: Driver's Door Wire Harness

Connector or Terminal	Ref	Cavities	Location	Connects to	Notes
Under-dash fuse/relay box connector J	6	21	Left kick panel		
Under-dash fuse/relay box connector K	7	12	Left kick panel		
C631	5	20	Driver's door	Driver's door wire harness	
C632	8	17	Driver's door	Driver's door wire harness	

G01820823

Fig. 40: Driver's Door Subharness

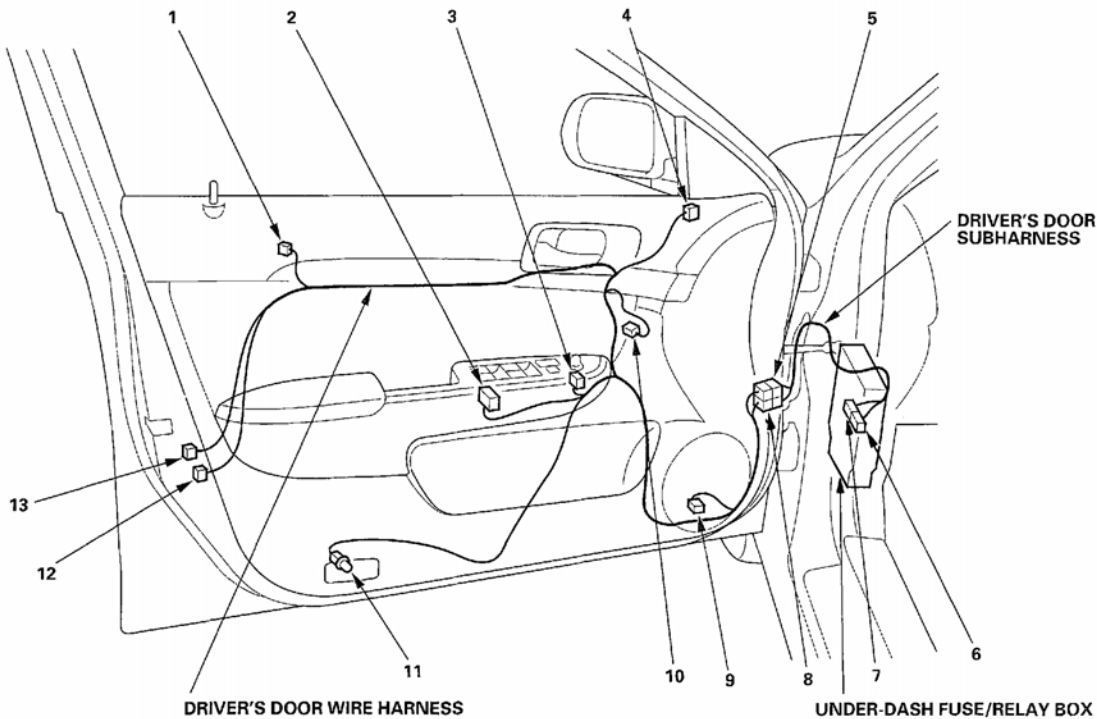

G01820824

Fig. 41: Locating Driver's Door Wire Harness & Driver's Door Subharness

2004 Acura TSX

2004 ELECTRICAL Body Electrical Connectors & Harnesses - TSX

Connector or Terminal	Ref	Cavities	Location	Connects to	Notes
Front passenger's door courtesy light	5	2	Front passenger's door		
Front passenger's door lock actuator	4	2	Front passenger's door		
Front passenger's door lock switch	2	3	Front passenger's door		
Front passenger's door lock knob switch	3	3	Front passenger's door		
Front passenger's door speaker	8	2	Front passenger's door		
Front passenger's power window motor	7	6	Front passenger's door		
Front passenger's power window switch	6	6	Front passenger's door		
Right power mirror/right side turn signal light	1	13	Front passenger's door		
C731	9	13	Under right side of dash	Dashboard wire harness	
C732	10	12	Under right side of dash	Dashboard wire harness	

G01820825

Fig. 42: Front Passenger's Door Wire Harness

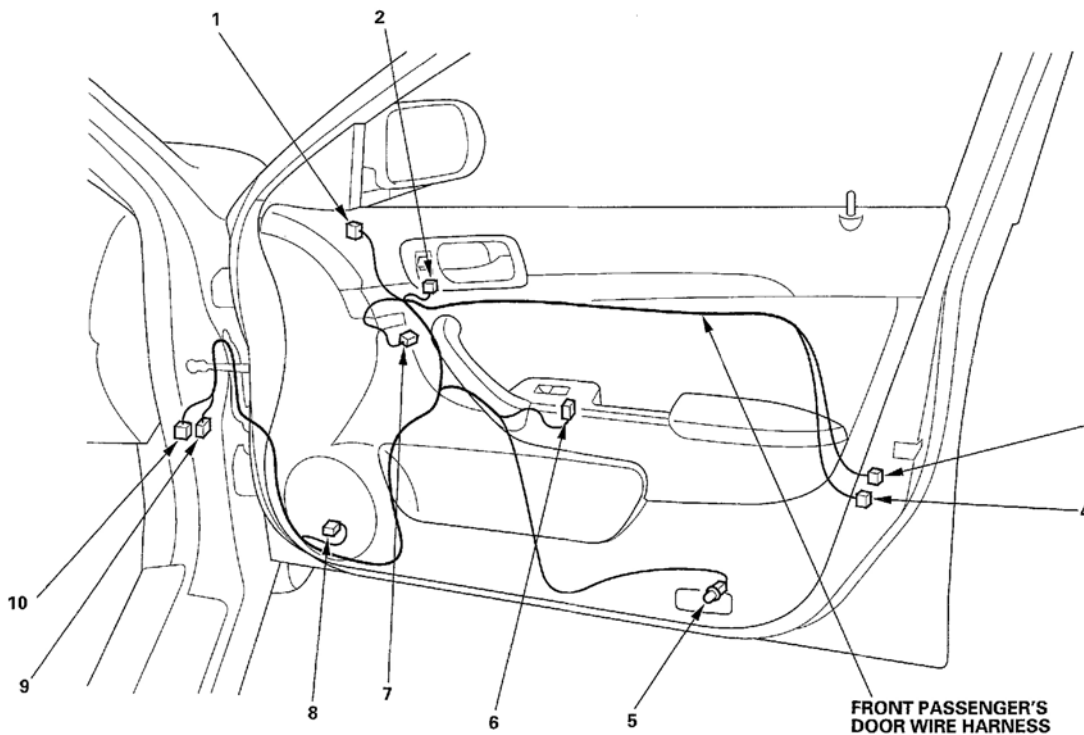

G01820826

Fig. 43: Locating Front Passenger's Door Wire Harness

Connector or Terminal	Ref	Cavities	Location	Connects to	Notes
Left rear door speaker	3	2	Left rear door		
Left rear power door lock actuator	5	2	Left rear door		
Left rear power door lock knob switch	6	3	Left rear door		
Left rear power window motor	1	6	Left rear door		
Left rear power window switch	4	6	Left rear door		
C751	2	17	Left B-pillar	Floor wire harness	

G01820827

Fig. 44: Left Rear Door Wire Harness

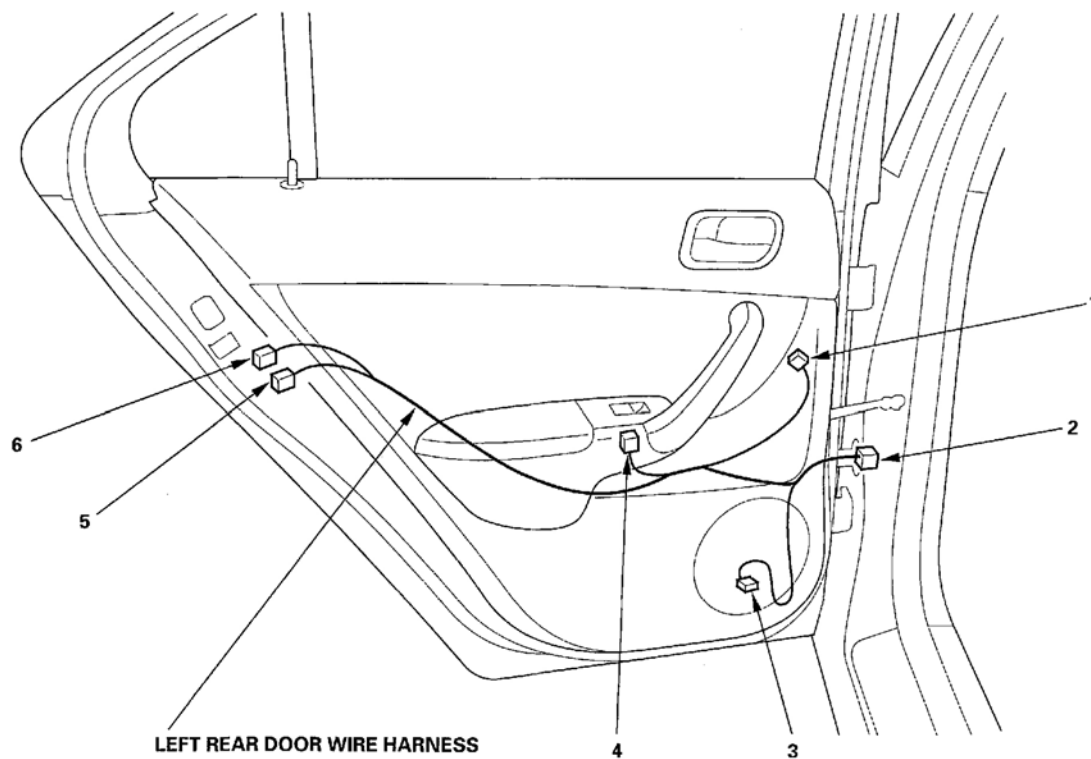

G01820828

Fig. 45: Locating Left Rear Door Wire Harness

Connector or Terminal	Ref	Cavities	Location	Connects to	Notes
Right rear door speaker	4	2	Right rear door	Floor wire harness	
Right rear power door lock actuator	2	2	Right rear door		
Right rear power door lock knob switch	1	3	Right rear door		
Right rear power window motor	6	6	Right rear door		
Right rear power window switch C781	3	6	Right rear door		
	5	17	Right B-pillar		

G01820829

Fig. 46: Right Rear Door Wire Harness

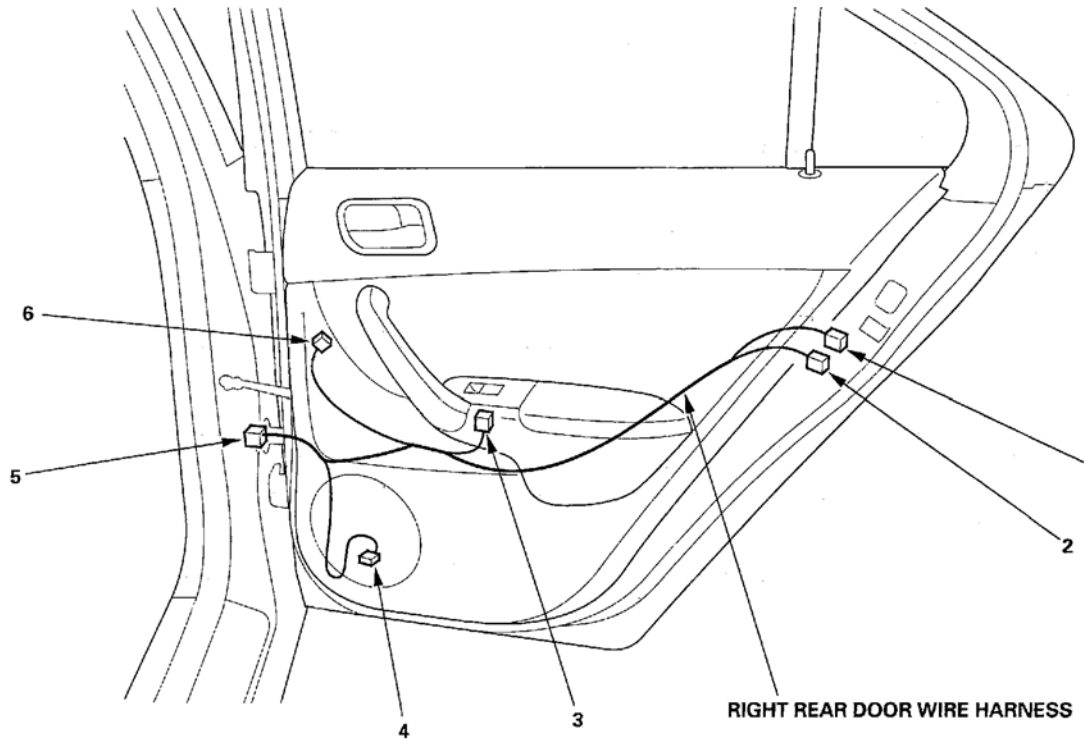

G01820830

Fig. 47: Locating Right Rear Door Wire Harness

Connector or Terminal	Ref	Cavities	Location	Connects to	Notes
Driver's airbag	15	4	Under left side of dash	Engine compartment wire harness	
Front passenger's airbag	5	4	Under right side of dash		
SRS unit connector A	2	28	Under middle of dash		
Under-dash fuse/relay box connector R	17	2	Under left side of dash		
Under-dash fuse/relay box connector S	18	2	Under left side of dash		
C403	1	4	Under left side of dash		
C501	16	24	Under left side of dash	Floor wire harness	
G505	12			Body ground, via dashboard wire harness	

G01820831

Fig. 48: Dashboard Wire Harness (SRS Branch)

Connector or Terminal	Ref	Cavities	Location	Connects to	Notes
Driver's seat belt tensioner	11	4	Left B-pillar	Dashboard wire harness	
Driver's side airbag	14	2	Under left side of dash		
Front passenger's seat belt tensioner	8	4	Right B-pillar		
Front passenger's side airbag	7	2	Under front passenger's seat		
Left side impact sensor (1st)	13	2	Under driver's seat		
Right side impact sensor (1st)	9	2	Under front passenger's seat		
SRS unit connector B	3	28	Under middle of dash	OPDS unit harness	
C501	16	24	Under light side dash		
C801	6	4	Under front passenger's seat		

G01820832

Fig. 49: Floor Wire Harness (SRS Branch)

2004 Acura TSX

2004 ELECTRICAL Body Electrical Connectors & Harnesses - TSX

Connector or Terminal	Ref	Cavities	Location	Connects to	Notes
OPDS unit C801	10 6	8 4	In front passenger's seat Under front passenger's seat	Floor wire harness	

G01820833

Fig. 50: OPDS Unit Harness

Connector or Terminal	Ref	Cavities	Location	Connects to	Notes
SRS unit connector C	4	16	Under middle of dash		

G01820834

Fig. 51: Side Curtain Airbag Harness

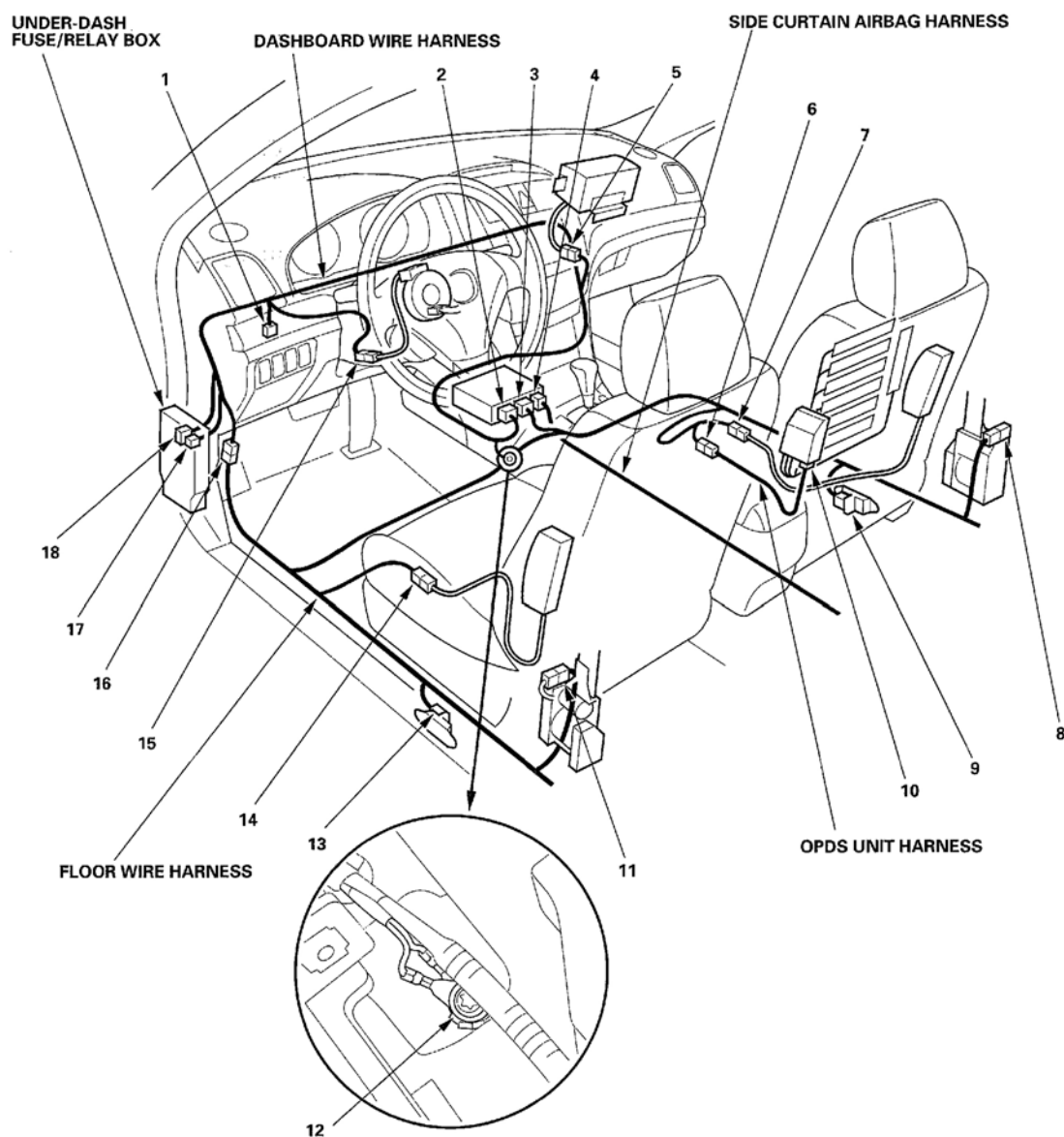

G01820835

Fig. 52: Locating SRS Harnesses

Connector or Terminal	Ref	Cavities	Location	Connects to	Notes
SRS unit connector A	1	28	Under middle of dash		

G01820836

Fig. 53: Dashboard Wire Harness (SRS Branch)

Connector or Terminal	Ref	Cavities	Location	Connects to	Notes
SRS unit connector B	2	28	Under middle of dash		

G01820837

Fig. 54: Floor Wire Harness (SRS Branch)

Connector or Terminal	Ref	Cavities	Location	Connects to	Notes
Left side impact sensor (2nd)	6	2	Left quarter panel		
Left side curtain airbag	7	2	Left C-pillar		
Right side curtain airbag	4	2	Right quarter panel		
Right side impact sensor (2nd)	5	2	Right C-pillar		
SRS unit connector C	3	16	Under middle of dash		

G01820838

Fig. 55: Side Curtain Airbag Harness

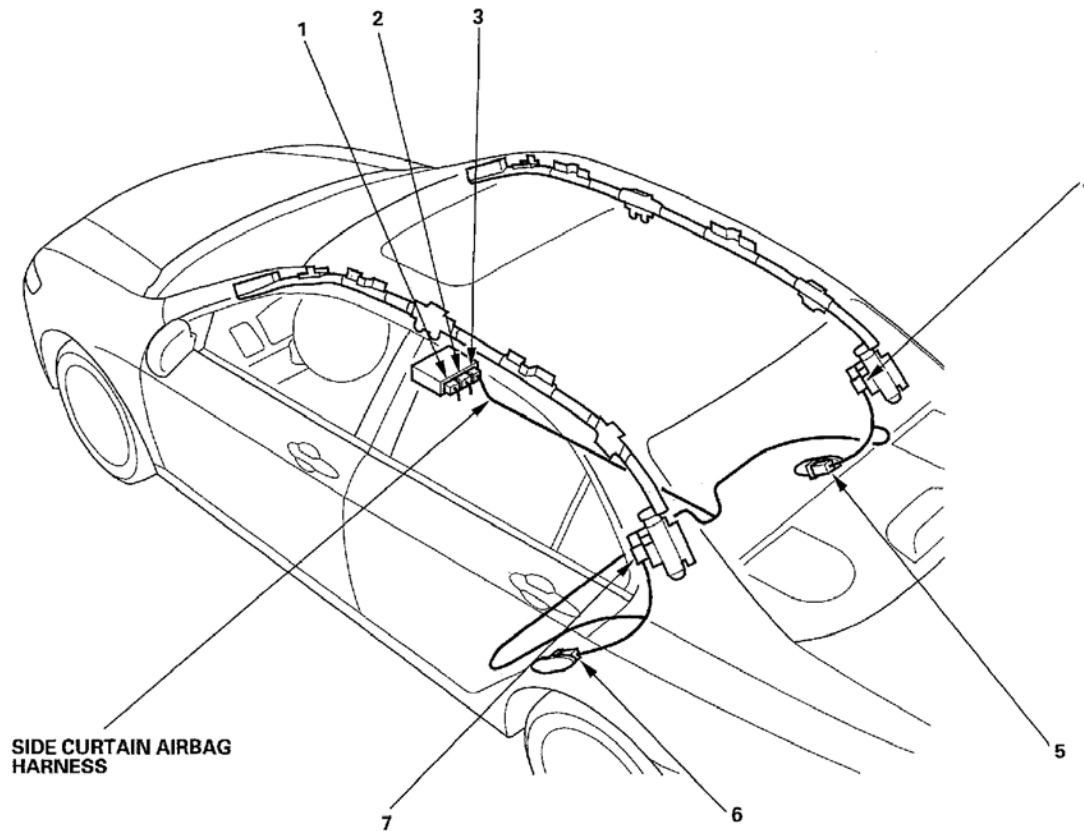

G01820839

Fig. 56: Locating SRS Harnesses

Connector or Terminal	Ref	Cavities	Location	Connects to	Notes
Driver's power seat adjustment switch	6	12	Left side of driver's seat		
Driver's seat belt switch	4	3	Under driver's seat		
Driver's seat heater	5	4	Under driver's seat		
Front up-down motor	7	2	Under driver's seat		
Rear up-down motor	1	2	Under driver's seat		
Recline motor	8	5	Under driver's seat		
Slide motor	2	2	Under driver's seat		
C901	3	10	Under driver's seat	Floor wire harness	

G01820840

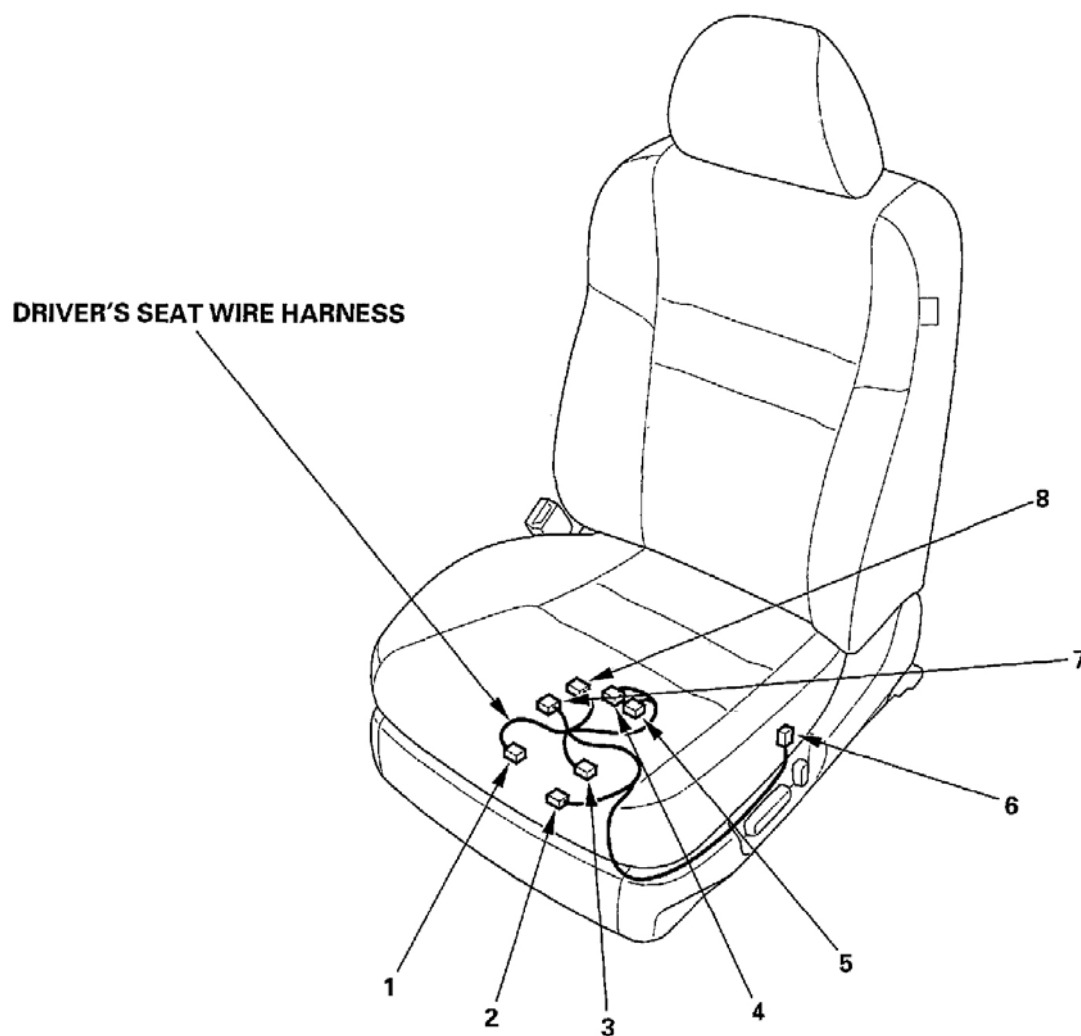
Fig. 57: Driver's Seat Wire Harness

G01820841

Fig. 58: Locating Driver's Seat Wire Harness

Connector or Terminal	Ref	Cavities	Location	Connects to	Notes
Driver's air mix control motor	5	7	Under middle of dash	Dashboard wire harness	
Evaporator temperature sensor	6	2	Under middle of dash		
Front passenger's air mix control motor	3	7	Under middle of dash		
Mode control motor	2	7	Under middle of dash		
Recirculation control motor	1	7	Under middle of dash		
C851	4	21	Under middle of dash		

G01820842

Fig. 59: A/C Wire Harness

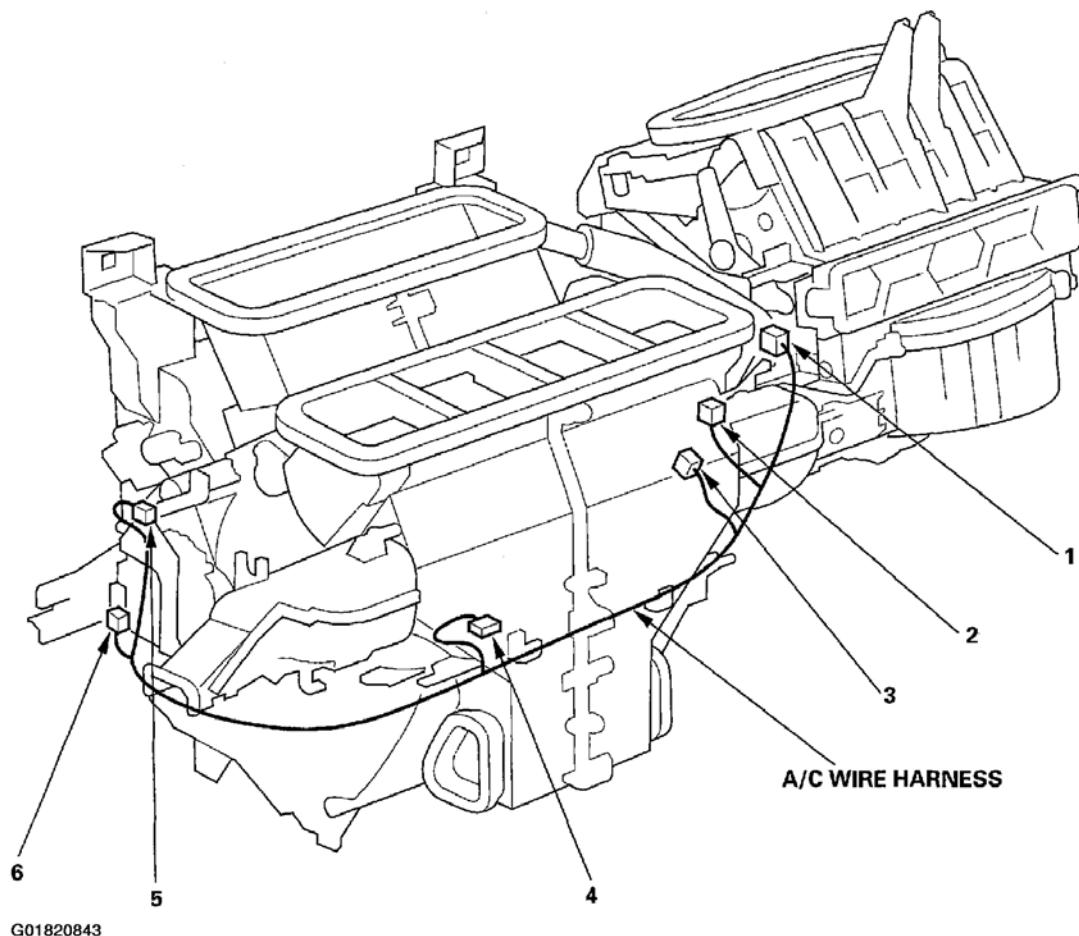

Fig. 60: Locating A/C Wire Harness

GROUND DISTRIBUTION

GROUND TO COMPONENTS INDEX

2004 Acura TSX

2004 ELECTRICAL Body Electrical Connectors & Harnesses - TSX

Ground	Component or circuit grounded
G1	Battery terminal
G2	Engine mount bracket
G3	Transmission housing
G101	ECM/PCM (PG1 and PG2 are BLK; LG1 and LG2 are BRN/YEL) BLK: A/T clutch pressure control solenoid valve A, A/T clutch pressure control solenoid valve B, A/T clutch pressure control solenoid valve C, Ignition coils, Mainshaft speed sensor (A/T), Thermal joints, Transmission range switch, Throttle actuator control module, VTEC solenoid valve BRN/YEL CKP sensor, CMP sensor A, CMP sensor B, Countershaft speed sensor, VTEC oil pressure switch Shielding between the ECM/PCM and knock sensor, throttle actuator control module and throttle body have BRN/YEL wire
G201	Condenser fan motor, Hood switch, Right headlights, Right front turn signal light, Right front parking light
G202	Brake fluid level switch, Power steering pressure (PSP) switch, Washer fluid level switch (Canada)
G203	VSA modulator-control unit
G301	Daytime running lights relay (Canada), Left headlights, Left front turn signal light, Left front parking light, Radiator fan motor, Radiator fan switch
G302	Blower motor relay, ELD unit, Relay control module, Windshield wiper motor
G501	Accessory power socket relay, Ambient light, Clutch interlock switch (M/T), Clutch pedal position switch (M/T), Combination switch control unit, Cruise control main switch, Data link connector (DLC), Driver's door lock knob switch, Driver's door key cylinder switch, Gauge control module, Ignition key switch, Key interlock solenoid, Moonroof switch, Moonroof open/close relays, Relay control module, Vanity mirror lights, VSA off switch (G501 connects to G601 via under-dash fuse/relay box)
G502	Multiplex integrated control unit (MICU)
G503	Automatic inside dimming mirror, Audio-HVAC sub display unit (with navigation), Climate control unit (audio-HVAC display module), Clock (without navigation), Console box light, Data link connector (DLC), Front accessory power socket, Front passenger's door lock switch, Front passenger's door lock knob switch, Front passenger's power window switch, Gauge control module, Glove box light, Memory erase signal (MES) connector, Navigation display unit (audio-HVAC display module), Power transistor, Park pin switch, Rear accessory power socket, Right power mirror defogger (Canada), Right side turn signal light, Transmission gear selection switch Shielding between the ECM/PCM, Gauge control module, Navigation unit and VSA modulator-control unit have BRN wire
G504	Audio unit (audio-HVAC display module), Stereo amplifier (2 wires)
G505	SRS unit
G506	Driver's seat heater switch, Front passenger's seat heater switch, Seat heater relay
G601	Driver's power seat switch (2 wires), Driver's seat belt switch, Driver's seat heater, Door multiplex control unit, Left power mirror defogger (Canada), Left rear door lock knob switch, Left power window switch, Left side turn signal light, Multiplex integrated control unit (MICU) (2 wires), MICU service check connector, Noise condenser, Power mirror switch, Turn signal/hazard relay, (G601 connects to G501 via under-dash fuse/relay box)
G602	Front passenger's seat belt switch, Front passenger's seat heater, High mount brake light, Navigation unit, OPDS unit, Right rear door lock knob switch, Right rear power window switch
G603	Fuel pump
G604	Rear window defogger
G701	Back-up lights, Brake lights, License plate lights, Rear turn signal lights, Rear side marker lights, Taillights, Trunk latch switch/trunk lid opener solenoid, Trunk lid opener switch

G01820854

Fig. 61: Ground to Components Index